

CERTIFIED LAND CORNER RESTORATION

34-10
Index No. R-20

State of Wisconsin }
County of Lan glade } ss.

I Raymond J. Hallisy, do hereby certify that on the 5th day of May, 19 69, I found evidence of the E 1/16 corner of Section 23 Township 34, North, Range 10E, Fourth, Principal Meridian, as described hereon; and that from this evidence I established a new monument and accessories as described hereon to perpetuate the original location of this corner.

History of original corner establishment:

Corner set in the 1930 resurvey.

Description of corner evidence found:

Found old stake standing marked E 1/16 S23 S26

Resident witnesses:

.....
.....
.....

Description of monument and accessories I established to perpetuate the original location of this corner.

**Set 2" pipe with brass cap and rock mound.
B.T.'s to corner
Red maple 10" S30E 9Ft. 7 inches
Red maple 8" N79E 15Ft. 1 inch
B.T.'s faced at base of tree and scribed BT**

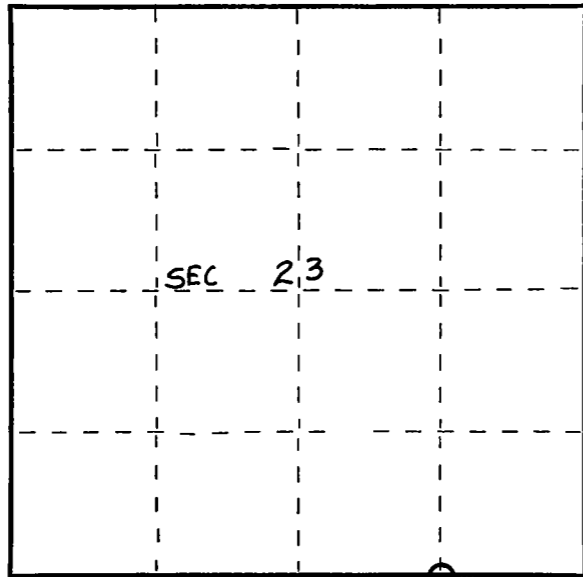
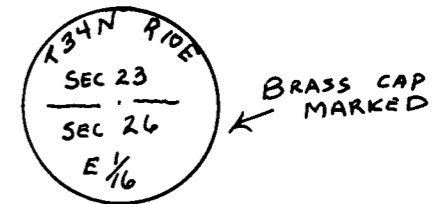

○ = Corner monument restored.

Dated at Antigo, Wis., this 5th day of May, 19 69.

Signature Raymond J. Hallisy Title Reg. Land Surveyor Registration No. S-685
(County Surveyor, Registered Land Surveyor, or other duly authorized official)

Office of Register of Deeds, County of _____, I hereby certify that the within instrument was filed in this office for record on the _____ day of _____, 19 _____ at _____ o'clock _____ M.

.....
(Register of Deeds)

By _____ Deputy