

CERTIFIED LAND CORNER RESTORATION

Index No. E-16

State of Wisconsin }
County of Langlade } ss.

I Glen Barker, do hereby certify that on the 31st day of October, 19 83, I ~~found~~ established ~~corner of the~~ E 1/16 corner of Sections 22 & 27 Township 34, North, Range 10 East, Fourth Principal Meridian, as described hereon; and that from this evidence I established a new monument and accessories as described hereon to perpetuate the original location of this corner.

Resident witnesses:

J. Claflin, Reg.

H. Wagoner

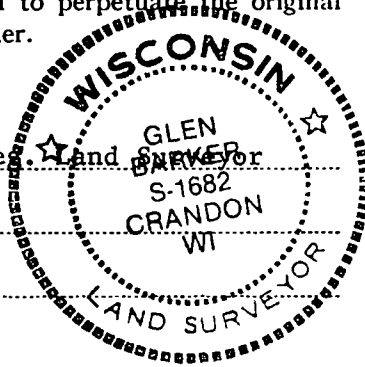

Stock No. 26272
FORM 985
H.C. Miller Company
Madison, Wisconsin

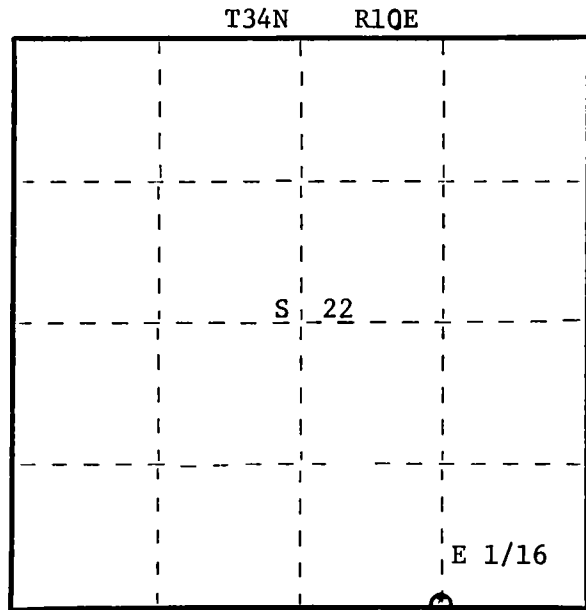

○ = Corner monument restored.

History of original corner establishment:

No evidence of any previous corner.

Description of corner evidence found:

Total distance from section corner 22-23-26-27 to 1/4 corner between sections 22 & 27 is 2496.58 feet.

Set E 1/16 1248.29 feet intermediate.

Description of monument and accessories I established to perpetuate the original location of this corner.

Set a 1" iron pipe with 2" diameter alloy cap, stamped:
Monument projects 12" above ground.

Marked NBT's:

Cedar 6" N 4°E 32.38 feet
Cedar 5" N82°W 17.64 feet
scribed 1/16-B.T.

S1682
T34N R10E
E 1/16 S | 22
 S | 27
 CPI-1983

Dated at Rhineland, Wis., this 19th day of December, 19 83.

Signature Glen Barker Title Registered Land Surveyor Registration No. S-1682
(County Surveyor, Registered Land Surveyor, or other duly authorized official)

Office of Register of Deeds, County of _____, I hereby certify that the within instrument was filed in this office for record on the _____ day of _____, 19 _____ at _____ o'clock _____ M.

(Register of Deeds)

By _____ Deputy