

CERTIFIED LAND CORNER RESTORATION

Index No. R-17

State of Wisconsin }  
County of Langlade } ss.

I Raymond J. Hallisy, do hereby certify that on the 6th day of April, 1980, I found evidence of the Section corner of 22, 23, 26, & 27 Township 34 of 10E, North, Range as described hereon; and that from this evidence I established a new monument and accessories as described hereon to perpetuate the original location of this corner.

Resident witnesses:

.....  
.....  
.....

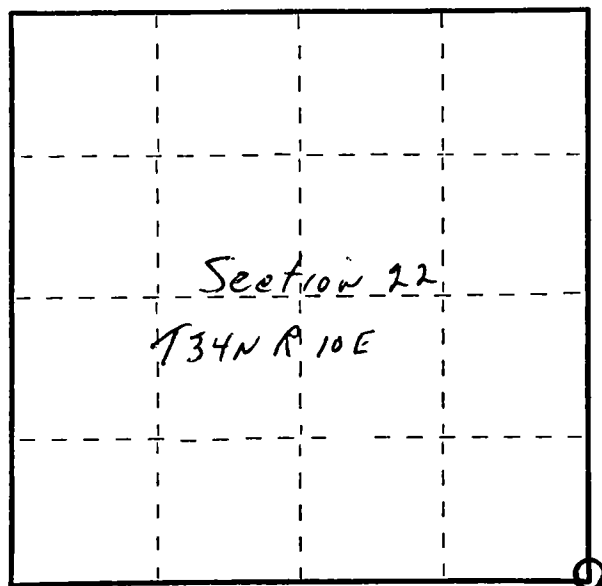

○ = Corner monument restored.

History of original corner establishment:

4" iron pipe with brass cap set in the 1930 resurvey.

Description of corner evidence found:

4" iron pipe with brass cap.

Description of monument and accessories I established to perpetuate the original location of this corner.

New BT's

5" Hard Maple N24W 6'3"  
6" Hard Maple S79W 13'4"  
12" Hard Maple S30W 15'2"

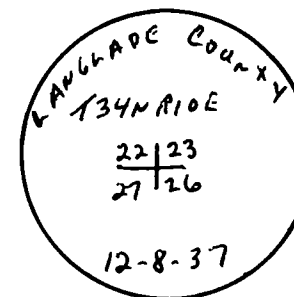

Dated at Antigo, Wis., this 6th day of April, 1980.

Signature Raymond J. Hallisy Title Land Surveyor Registration No. S-685  
(County Surveyor, Registered Land Surveyor, or other duly authorized official)

Office of Register of Deeds, County of \_\_\_\_\_, I hereby certify that the within instrument was filed in this office for record on the \_\_\_\_\_ day of \_\_\_\_\_, 19\_\_\_\_ at \_\_\_\_\_ o'clock \_\_\_\_\_ M.

.....  
(Register of Deeds)

By.....Deputy