

CERTIFIED LAND CORNER RESTORATION

34-10
Index No. P-11

State of Wisconsin }
County of Langlade } ss.

History of original corner establishment:

Corner set in the 1950's by Langlade County Forestry Personnel

I Raymond J. Hallisy, do hereby certify that on the 27th day of July, 19 68, I found evidence of the Center corner of Section 21 Township 34, North, Range 10, Fourth Principal Meridian, as described hereon; and that from this evidence I established a new monument and accessories as described hereon to perpetuate the original location of this corner.

Description of corner evidence found:

Found wood stake standing marked C 1/4 S 21

Resident witnesses:

Description of monument and accessories I established to perpetuate the original location of this corner.

Set Brass Cap in cement 3' deep 4" thick, 1 1/2' above ground

FORM 985 H. C. MILLER CO., MILWAUKEE

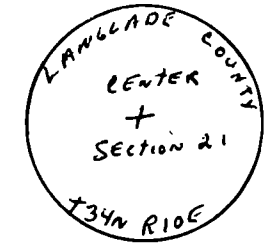
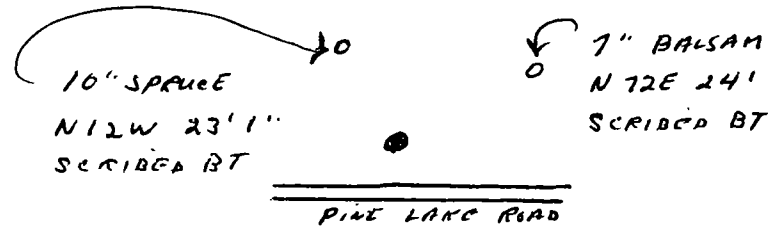
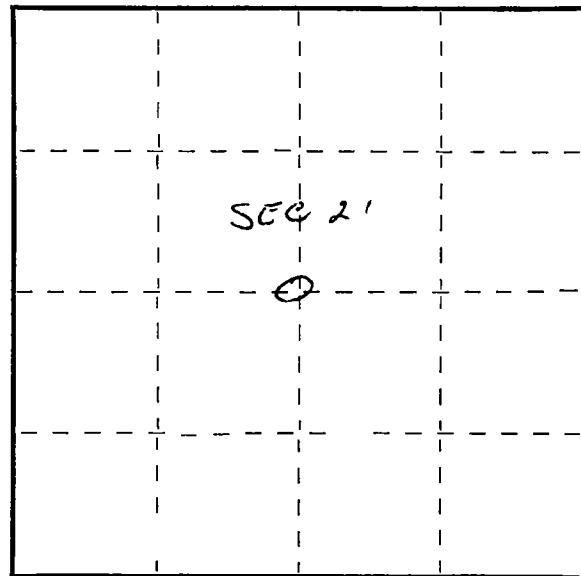

Dated at Antigo, Wis., this 27th day of July, 19 68

Signature Raymond J. Hallisy Title Reg. Land Surveyor Registration No. 2685
(County Surveyor, Registered Land Surveyor, or other duly authorized official)

Office of Register of Deeds, County of _____, I hereby certify that the within instrument was filed in this office for record on the _____ day of _____, 19 _____ at _____ o'clock _____ M.

(Register of Deeds)

○ = Corner monument restored.

By _____ Deputy