

CERTIFIED LAND CORNER RESTORATION

34-10
Index No. Q-13

State of Wisconsin }
County of Lanark } ss.

I, Raymond Hallisy, do hereby certify that on the 28th day of October, 1972, I found evidence of the S 1/16 corner of Section 21 Township 34, North, Range 10E, Fourth, Principal Meridian, as described hereon; and that from this evidence I established a new monument and accessories as described hereon to perpetuate the original location of this corner.

Resident witnesses:

History of original corner establishment:

Corner Set in The 1930 Resurvey

Description of corner evidence found:

Corner Standing
Old BT
Hemlock 12" S 75 W 9.5 FT

Description of monument and accessories I established to perpetuate the original location of this corner.

Set 2" pipe with brass cap
New BT's
Hemlock 9" N 66 W 13 FT 3 in.
Hemlock 11" S 55 E 6 FT

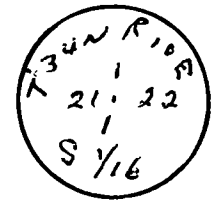

FORM 985 H. C. MILLER CO., MILWAUKEE

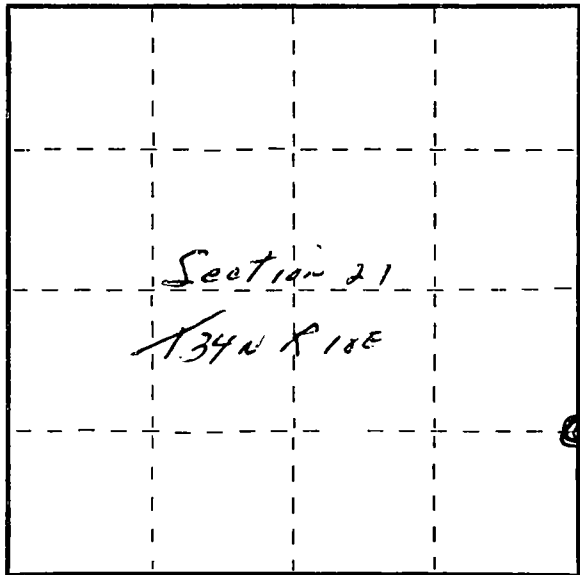

○ = Corner monument restored.

Dated at Antigo, Wis., this 28th day of October, 1972.

Signature Raymond Hallisy Title Reg. Land Surveyor Registration No. 5685
(County Surveyor, Registered Land Surveyor, or other duly authorized official)

Office of Register of Deeds, County of _____, I hereby certify that the within instrument was filed in this office for record on the _____ day of _____, 19____ at _____ o'clock _____ M.

(Register of Deeds)

By _____ Deputy