

CERTIFIED LAND CORNER RESTORATION

Index No. R-7

State of Wisconsin }
County of Lantern } ss.

I Raymond J. Hallisy, do hereby certify that on the 15th day of May, 1976, I found evidence of the 1/4 corner of Section 20 & 29 Township Elche 34 North, Range 10 E, Fourth Principal Meridian, as described hereon; and that from this evidence I established a new monument and accessories as described hereon to perpetuate the original location of this corner.

Resident witnesses:

.....
.....
.....

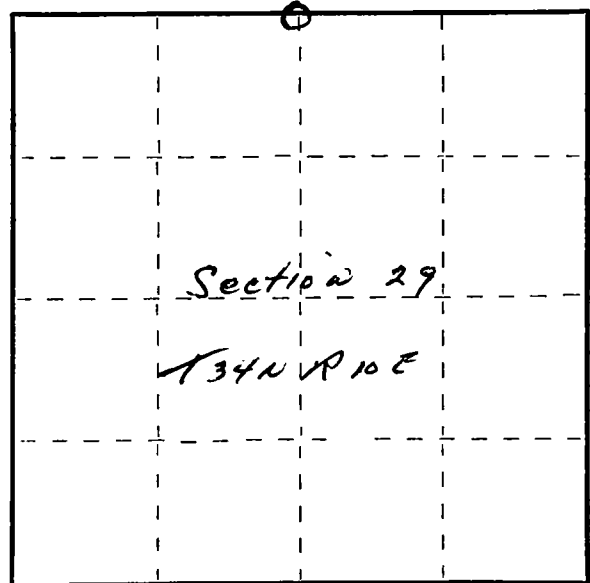

○ = Corner monument restored.

History of original corner establishment:

CORNER Set 10/7/37

Description of corner evidence found:

4" pipe with BRASS cap

Description of monument and accessories I established to perpetuate the original location of this corner.

BT's

8" Hard Maple S 42W 35' 2"

8" Hard Maple S 73W 32' 8"

8" Basswood N 45W 19' 3"

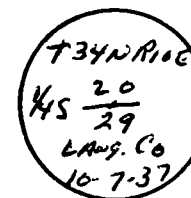

Dated at Antigo, Wis., this 15th day of May, 1976.

Signature Raymond J. Hallisy Title Reg. Land Surveyor Registration No. S-685
(County Surveyor, Registered Land Surveyor, or other duly authorized official)

Office of Register of Deeds, County of _____, I hereby certify that the within instrument was filed in this office for record on the _____ day of _____, 19____ at _____ o'clock _____ M.

.....
(Register of Deeds)

By..... Deputy