

CERTIFIED LAND CORNER RESTORATION

34-10
Index No. R-8

State of Wisconsin }
County of Langlade } ss.

I Raymond J. Hallisy, do hereby certify that on the 25th day of May, 1968, I found evidence of the E 1/16 corner of Section 20 Township 34, North, Range 10, Fourth, Principal Meridian, as described hereon; and that from this evidence I established a new monument and accessories as described hereon to perpetuate the original location of this corner.

History of original corner establishment:

Corner set in the 1930's by: C. W. Borth
E. F. Kowalke
D. A. Hintz

Description of corner evidence found:

Found squared stake down - point intact
Stake marked E 1/8 S20 S29

Resident witnesses:

.....
.....
.....

Description of monument and accessories I established to perpetuate the original location of this corner.

Set Std. 1 1/2" pipe with cap marked E 1/16

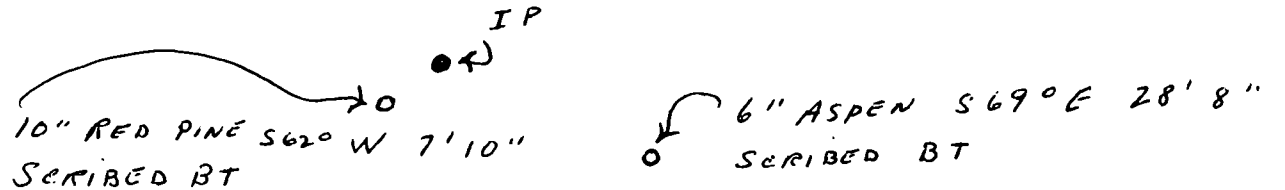
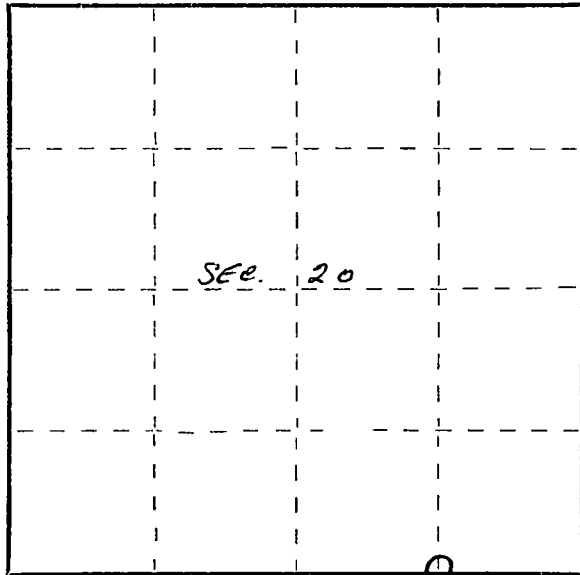

Dated at Antigo, Wis., this 25th day of May, 1968.

Signature Raymond J. Hallisy Title Reg. Land Surveyor Registration No. 2685
(County Surveyor, Registered Land Surveyor or other duly authorized official)

Office of Register of Deeds, County of....., I hereby certify that the within instrument was filed in this office for record on the..... day of....., 19..... at..... o'clock..... M.

.....
(Register of Deeds)

By..... Deputy

○ = Corner monument restored.

FORM 985 H. C. MILLER CO. - MILWAUKEE