

CERTIFIED LAND CORNER RESTORATION

Index No. 2-5

State of Wisconsin }  
County of Langlade } ss.

History of original corner establishment:

34 10

I Raymond J. Hallisy, do hereby certify that on the 8th day of April, 19 79, I found evidence of the 1/4 corner of Section 17 & 18 Township 34, North, Range 10E, Fourth Principal Meridian, as described hereon; and that from this evidence I established a new monument and accessories as described hereon to perpetuate the original location of this corner.

Corner set in the 1930 resurvey.

Description of corner evidence found:

4" pipe down and out of ground  
Rock B.O. with X N53E 86.9 Links

4/17/96 D.T.  
FOUND MON. 20' E W OF RD E.

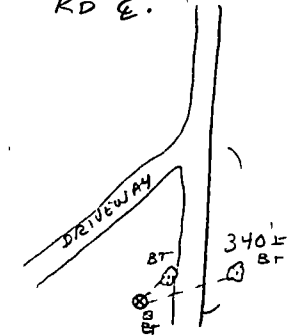

Resident witnesses:

Description of monument and accessories I established to perpetuate the original location of this corner.

Reset 4" pipe with brass cap by measuring from B.O. and locating hole and rock mound.  
New BT's

3" Tamarack S6E 4.4 Links  
10" Tamarack N56E 110.3 Links  
18" Tamarack N30E 26.2 Links

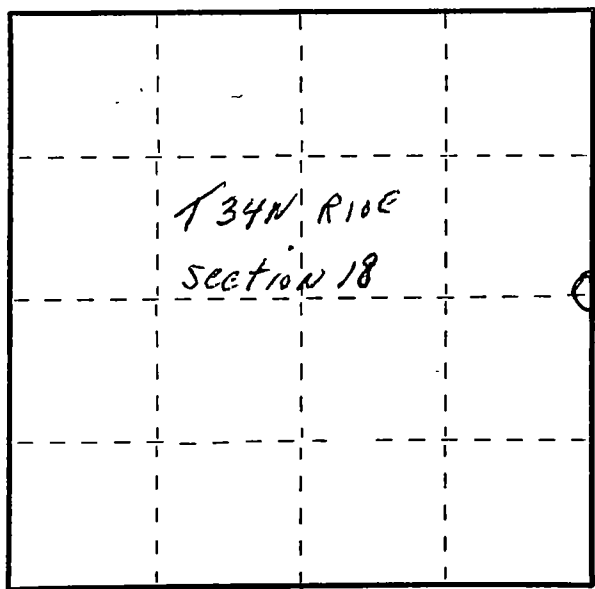
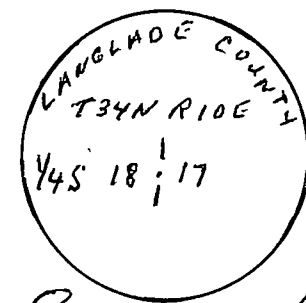

○ = Corner monument restored.

Dated at Antigo, Wis., this 8 day of April, 1979

Signature Raymond J. Hallisy Title Lang. Land Surveyor Registration No. 5-685  
(County Surveyor, Registered Land Surveyor, or other duly authorized official)

Office of Register of Deeds, County of \_\_\_\_\_, I hereby certify that the within instrument was filed in this office for record on the \_\_\_\_\_ day of \_\_\_\_\_, 19\_\_\_\_ at \_\_\_\_\_ o'clock \_\_\_\_\_ M.

(Register of Deeds)

By \_\_\_\_\_ Deputy