

CERTIFIED LAND CORNER RESTORATION

Index No. M-5

State of Wisconsin }
County of Langlade } ss.

I Raymond J. Hallisy, do hereby certify that on the 11th day of June, 19 68, I found evidence of the S 1/16 corner of Section 18 Township 34, North, Range 10, Fourth, Principal Meridian, as described hereon; and that from this evidence I established a new monument and accessories as described hereon to perpetuate the original location of this corner.

History of original corner establishment:

Corner set in the 1930's by: C. W. Borth
E. F. Kowalke
D. A. Hintz

Description of corner evidence found:

Found squared stake down point intact.
Marked S17 S18 S 1/16 Cor 20 lks E.

Resident witnesses:

.....
.....
.....

Description of monument and accessories I established to perpetuate the original location of this corner.

Set Std. $1\frac{1}{2}$ " pipe with cap marked W.C. C. 20 LKS. E. S 1/16 rock mound ~~BT~~ BT's to witness corner.

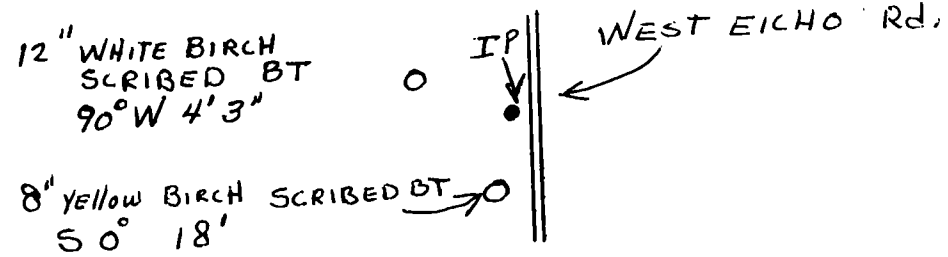
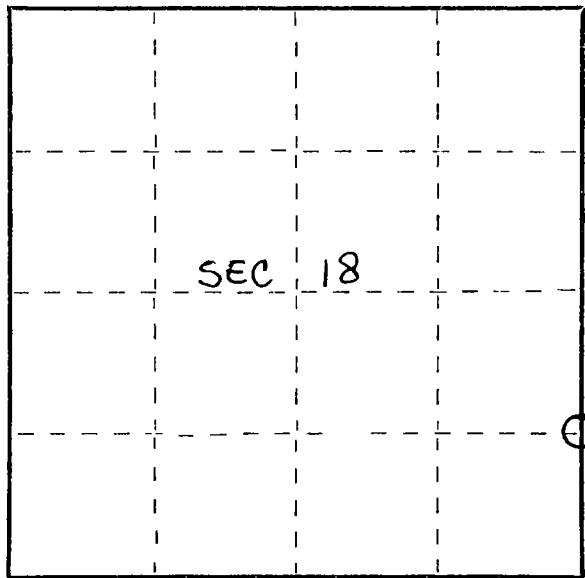

Dated at Antigo, Wis., this 11th day of June, 19 68.

Signature Raymond J. Hallisy Title Reg. Land Surveyor Registration No. S-685
(County Surveyor, Registered Land Surveyor, or other duly authorized official)

Office of Register of Deeds, County of _____, I hereby certify that the within instrument was filed in this office for record on the _____ day of _____, 19 _____ at _____ o'clock _____ M.

.....
(Register of Deeds)

By _____ Deputy

○ = Corner monument restored.

FORM 985 H. C. MILLER CO., MILWAUKEE