

CERTIFIED LAND CORNER RESTORATION

Index No. N-23

State of Wisconsin }
County of LANGLADE } ss.

I WILLIAM F. KELLY, do hereby certify that on the 7th day of DECEMBER, 1982, I found evidence of the SOUTH 1/4 corner of SECTION 13 Township 34, North, Range 10 EAST, Fourth Principal Meridian, as described hereon; and that from this evidence I established a new monument and accessories as described hereon to perpetuate the original location of this corner.

Resident witnesses:

RODNEY VISSER
.....
.....
.....

FORM 985 W & M L L R CO., MILWAUKEE

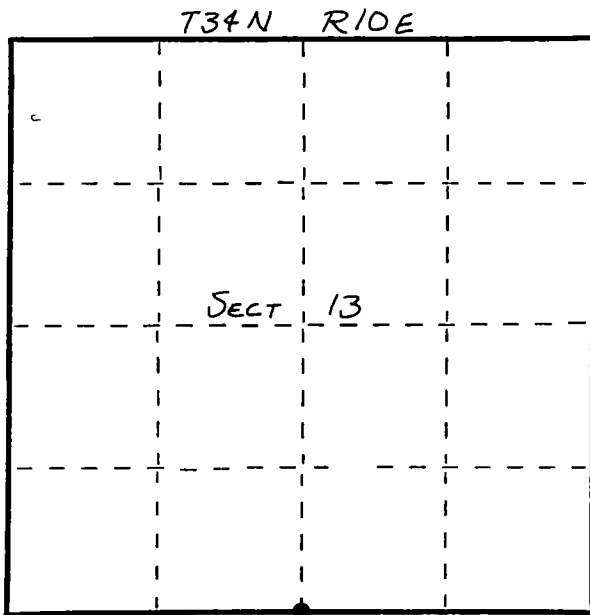

○ = Corner monument restored.

History of original corner establishment:
ORIGINAL CORNER ESTABLISHED BY
JAMES L. NOWLIN IN JULY, 1866

Description of corner evidence found:

FOUND IN PLACE: 4" BRASS
CAPPED MONUMENT.
MARKED 3 BT'S, ALL NEW
MON. EST. BY CCC IN 1938

SEE OVER



William F. Kelly
12-14-82

Description of monument and accessories I established to perpetuate the original location of this corner.

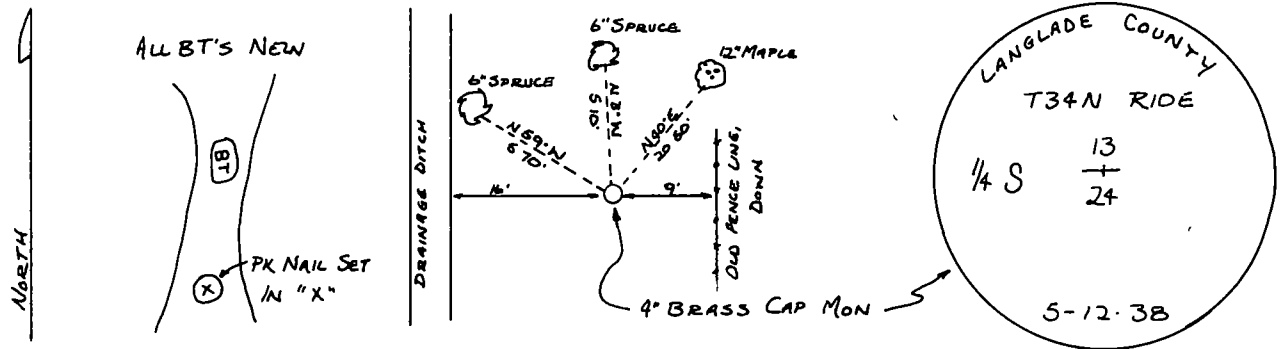

Dated at ELCHO, Wis., this 7th day of DECEMBER, 1982.

Signature William F. Kelly Title COUNTY SURVEYOR Registration No. 1098
(County Surveyor, Registered Land Surveyor, or other duly authorized official)

Office of Register of Deeds, County of....., I hereby certify that the within instrument was filed in this office for record on the..... day of....., 19..... at..... o'clock..... M.

(Register of Deeds)

By..... Deputy

3/95

D.T. CUSTY

FROM CUR SHOWN ON FRONT SIDE OF THIS FORM,

APPROX. 200' SOUTH IS OLD 2" OD IRON PIPE, UP 2" FROM WHICH

VERY OLD BT'S:

HEM, 18", N29E 7' ±

MAPLE 18, S42E 13 ±

CEDAR 4 SOUTH 19'

THIS WAS SHOWN TO ME BY MR. G. W. WOLLS &

MIGHT BE WORTH CHECKING ON FURTHER