

CERTIFIED LAND CORNER RESTORATION

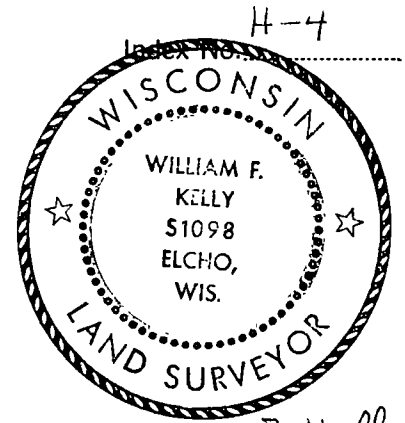

William F. Kelly

State of Wisconsin }
 County of LANGLADE } ss.

History of original corner establishment:
CORNER SET BY M. HUTCHINSON FOR "THE BOARS NEST" IN 1930.

I WILLIAM F. KELLY, do hereby certify that on the 8th day of APRIL, 1975, I found evidence of the SE 1/16 corner of SECTION 7 Township 34, North, Range 10 E, Fourth Principal Meridian, as described hereon; and that from this evidence I established a new monument and accessories as described hereon to perpetuate the original location of this corner.

Description of corner evidence found:

FOUND METAL FENCE POST AND TWO BEARING TREES. METAL POST REPLACED WOOD POST THAT WAS ROTTED AWAY.

Resident witnesses:

J. Drew

D. Kelly

Description of monument and accessories I established to perpetuate the original location of this corner.

SET 1/2" BLACK IRON PIPE WITH BRASS CAP. FENCE POST RESET AS WITNESS POST TO BRASS CAP. BRASS CAP MARKED:

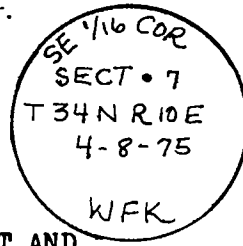

NOTE: NEW BEARING TREES SCRIBED NBT AND MARKED WITH A CROSS AT BASE. CORNER LOCATED IN A CEDAR SWAMP.

FORM 983 H. C. MILLER CO., MILWAUKEE

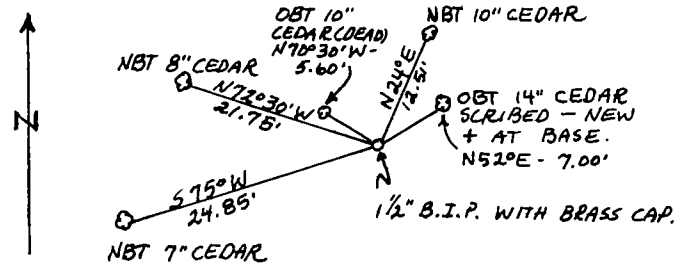
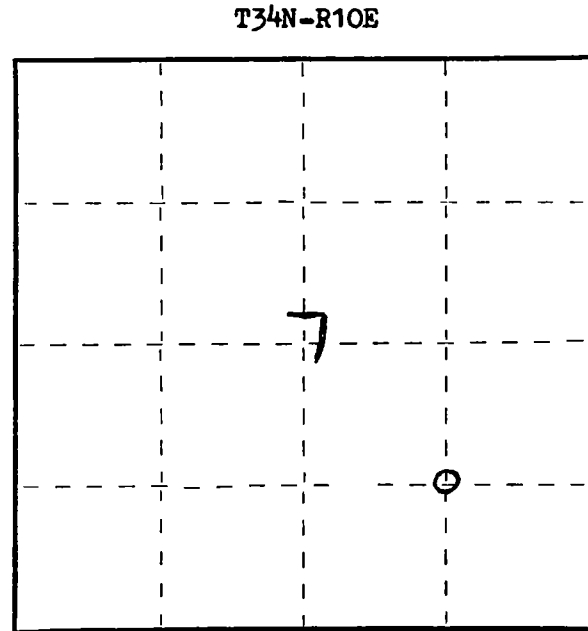

Dated at ELCHO, Wis., this 8th day of APRIL, 1975.

Signature William F. Kelly Title REGISTERED LAND SURVEYOR Registration No. S 1098
 (County Surveyor, Registered Land Surveyor, or other duly authorized official)

Office of Register of Deeds, County of _____, I hereby certify that the within instrument was filed in this office for record on the _____ day of _____, 19____ at _____ o'clock _____ M.

 (Register of Deeds)

By _____ Deputy

○ = Corner monument restored.