

CERTIFIED LAND CORNER RESTORATION

3A-10

Index No. J-4

State of Wisconsin }  
County of Lanlade } ss.

I Raymond J. Hallisy, do hereby certify that on the 11th day of June, 1968, I found evidence of the E 1/16 corner of Section 18 Township 34, North, Range 10, Fourth, Principal Meridian, as described hereon; and that from this evidence I established a new monument and accessories as described hereon to perpetuate the original location of this corner.

History of original corner establishment:

Corner set in the 1930's by: C. W. Borth  
E. F. Kowalke  
D. A. Hintz

Description of corner evidence found:

Found squared stake with 1" pipe along side, rock mound.  
Marked S7 S18 ~~XXXX~~ E 1/16

Resident witnesses:

.....  
.....  
.....

Description of monument and accessories I established to perpetuate the original location of this corner.  
Set Std. 1 1/2" pipe with cap marked 7 18 E 1/16

BASS LK. Rd.

FORM 085 H. C. MILLER CO., MILWAUKEE

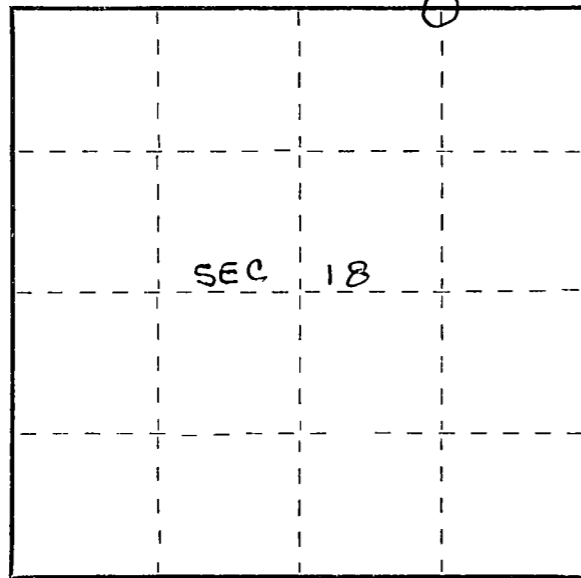

6" ELM SCRIBED BT →  
N 4°W 32' 1" IP

← 14" HARD MAPLE SCRIBED BT  
S 3°W 61' 6"

Dated at Antigo, Wis., this 11th day of June, 1968

Signature Raymond J. Hallisy Title Reg Land Surveyor Registration No. S-685  
(County Surveyor, Registered Land Surveyor, or other duly authorized official)

Office of Register of Deeds, County of \_\_\_\_\_, I hereby certify that the within instrument was filed in this office for record on the \_\_\_\_\_ day of \_\_\_\_\_, 19\_\_\_\_ at \_\_\_\_\_ o'clock \_\_\_\_\_ M.

(Register of Deeds)

By \_\_\_\_\_ Deputy

○ = Corner monument restored.