

CERTIFIED LAND CORNER RESTORATION

84-9

Index No. W-5

State of Wisconsin }  
County of LANGLADE } ss.

History of original corner establishment:  
SEC. COR 30-32 } ESTABLISHED BY HINTZ IN 1934 SURVEY  
31-32 }  
1/4 COR 31-32 }

I, WM F KELLY, do hereby certify that on the 25 day of JUNE, 19 74, I found evidence of the N 1/8 COR corner of SECS. 31-32 Township 34, North, Range 9 EAST, Fourth Principal Meridian, as described hereon; and that from this evidence I established a new monument and accessories as described hereon to perpetuate the original location of this corner.

Description of corner evidence found:  
SET COR MIDWAY BETWEEN SEC. & 1/4 COR.  
FOUND 1" GALV STEEL PIPE 33' EAST of COR.  
AT FENCE LINE

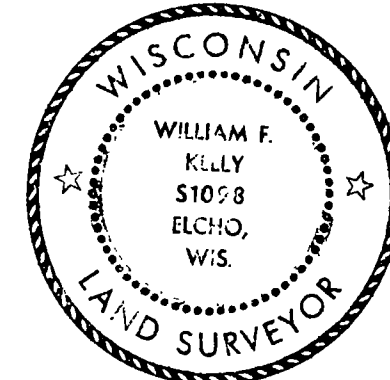

*William F. Kelly*  
25 June 1974

Resident witnesses:

Description of monument and accessories I established to perpetuate the original location of this corner.

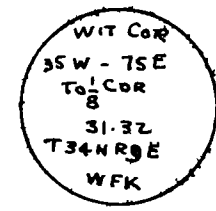
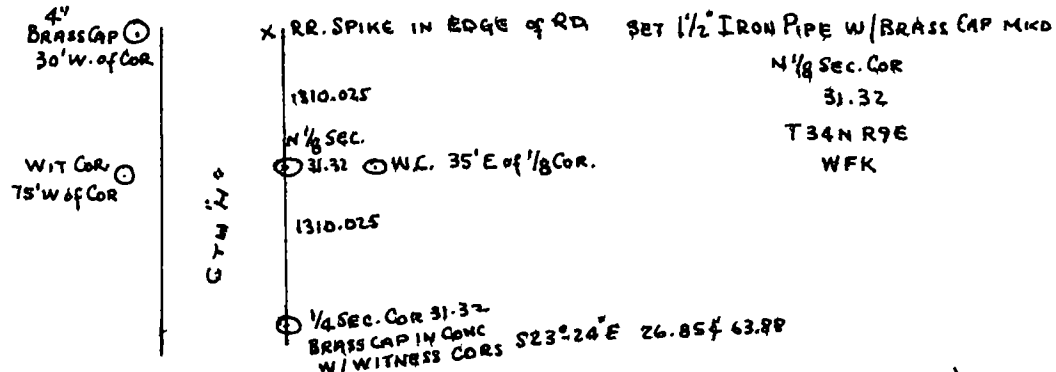
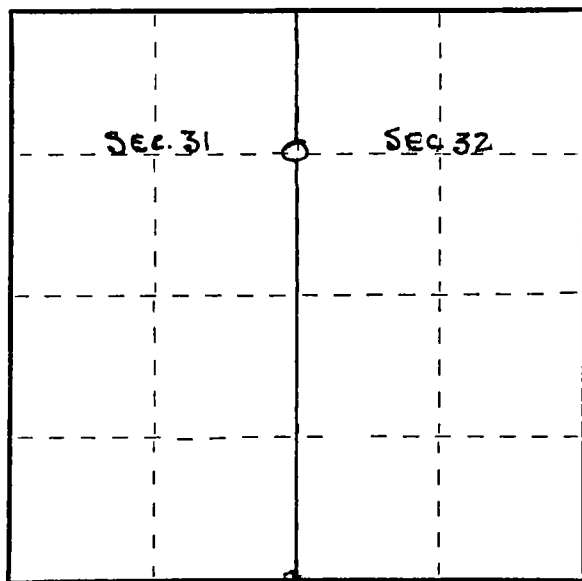

Dated at ELCHO, Wis., this 25 day of JUNE, 19 74

Signature William F. Kelly Title REG. LAND SURVEYOR Registration No. 1098  
(County Surveyor, Registered Land Surveyor, or other duly authorized official)

Office of Register of Deeds, County of \_\_\_\_\_, I hereby certify that the within instrument was filed in this office for record on the \_\_\_\_\_ day of \_\_\_\_\_, 19 \_\_\_\_\_ at \_\_\_\_\_ o'clock \_\_\_\_\_ M.

(Register of Deeds)

By \_\_\_\_\_ Deputy

○ = Corner monument restored.