

CERTIFIED LAND CORNER RESTORATION

34-9  
Index No. W-17

State of Wisconsin }  
County of Lan glade } ss.

I Raymond J. Hallisy, do hereby certify that on the 13th day of July, 1968, I found evidence of the N 1/16 corner of Section 34 Township 34, North, Range 9, Fourth Principal Meridian, as described hereon; and that from this evidence I established a new monument and accessories as described hereon to perpetuate the original location of this corner.

History of original corner establishment:

~~XX~~

Corner set in the 1930's by: T. H. Kilroe  
D. A. Hintz

Description of corner evidence found:

Found old stake down, marked 1/8 C 10 Ft W. also L. P. marked same.

Resident witnesses:

.....  
.....  
.....

Description of monument and accessories I established to perpetuate the original location of this corner.

Set Std. 1 1/2" pipe with cap marked N 1/16 W. C. Cor 10 Ft W, Rock mound

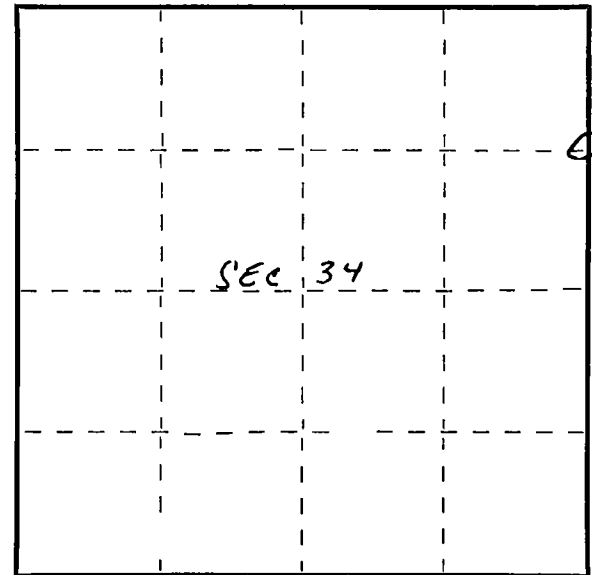

○ = Corner monument restored.

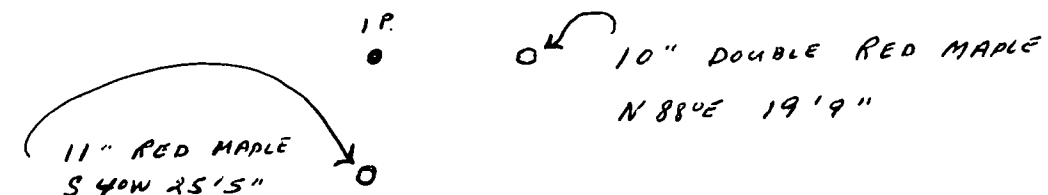

Dated at Antigo, Wis., this 13th day of July, 1968.

Signature Raymond J. Hallisy Title Reg. Land Surveyor Registration No. 8685  
(County Surveyor, Registered Land Surveyor, or other duly authorized official)

Office of Register of Deeds, County of \_\_\_\_\_, I hereby certify that the within instrument was filed in this office for record on the \_\_\_\_\_ day of \_\_\_\_\_, 19\_\_\_\_ at \_\_\_\_\_ o'clock \_\_\_\_\_ M.

.....  
(Register of Deeds)

By \_\_\_\_\_ Deputy