

CERTIFIED LAND CORNER RESTORATION

34-9  
Index No. ZB-11

State of Wisconsin }  
County of LAWSON } ss.

I Raymond S. Halliday, do hereby certify that on the 19<sup>th</sup> day of MARCH, 1988, I found evidence of the 1/4 corner of S 4 S S 33 Township 33 S 34, North, Range 9E, Fourth Principal Meridian, as described hereon; and that from this evidence I established a new monument and accessories as described hereon to perpetuate the original location of this corner.

Resident witnesses:

.....  
.....  
.....

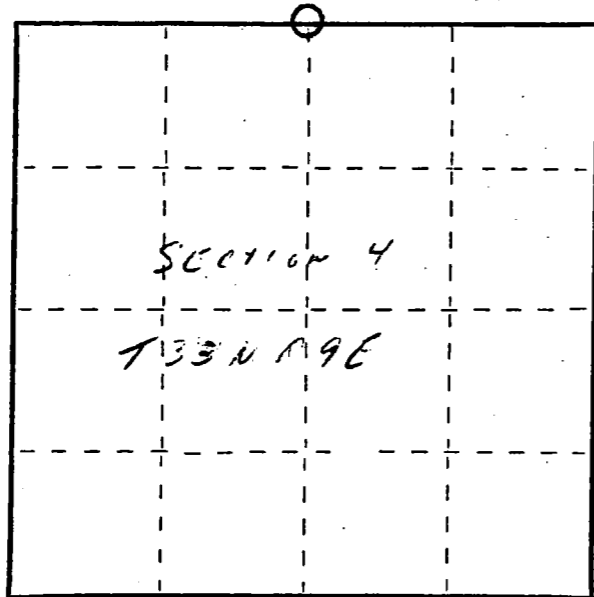

○ = Corner monument restored.

History of original corner establishment:

CORNER SET IN THE 1930 RESURVEY

Description of corner evidence found:

4" 1BX PINE WITH BRASS CAP

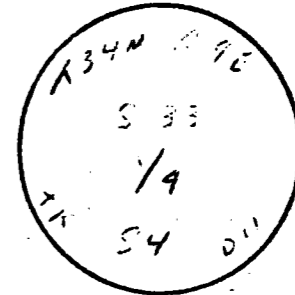

Description of monument and accessories I established to perpetuate the original location of this corner.

NEW BT'S

- 6" SPRUCE N60E 27' 8"
- 8" SPRUCE S80E 35' 4"
- 8" CHERRY N39W 12' 11"
- 10" RED MAPLE N26E 35' 8"

Dated at ANTHROP, Wis., this 19<sup>th</sup> day of MARCH, 1988

Signature Raymond S. Halliday Title SURVEYOR Registration No. 5185  
(County Surveyor, Registered Land Surveyor, or other duly authorized official)

Office of Register of Deeds, County of ....., I hereby certify that the within instrument was filed in this office for record on the ..... day of ....., 19..... at ..... o'clock ..... M.

.....  
(Register of Deeds)

By.....Deputy