

CERTIFIED LAND CORNER RESTORATION

Index No. 2A-9

State of Wisconsin }
County of LAWRENCE } ss.

History of original corner establishment:

34-9

1930's COUNTY RESURVEY PROJECT

I RAYMOND J. HALLISY do hereby certify that on the 20 day of MARCH, 1981, I found evidence of the SECTION CORNER corner of SEC. 5 Township 33, North, Range 9E, Fourth Principal Meridian, as described hereon; and that from this evidence I established a new monument and accessories as described hereon to perpetuate the original location of this corner.

Description of corner evidence found:

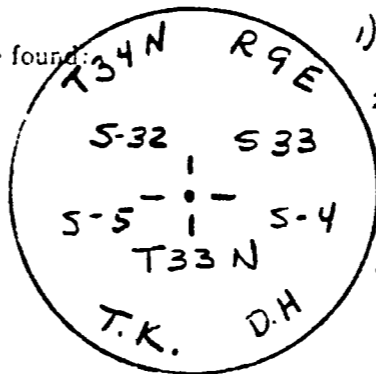

- 1930's BTS
- 1) ORIG CEDAR BT - MOSS COVER MOUND
 - 2) TAM 10" S35W 15.75 LINKS
3 FOOT STUB NO EVIDENCE OF SCRIBE MARK
 - 3) CEDAR 6" S32E 21.81 LKS
PRESENT

Resident witnesses:

SHIRLEY BARGANDER - DNR FORESTER

Description of monument and accessories I established to perpetuate the original location of this corner.

NEW BTS - SCRIBED B.T. AT BASIS

- 1) CEDAR 7" S32°W 22.0 LKS
- 2) CEDAR 5" S57°E 11.6 LKS
- 3) CEDAR 6" S74°W 25.0 LKS
- 4) CEDAR 7" N51°W 14.4 LKS

FORM 5013 R. C. MILLER CO., MILWAUKEE

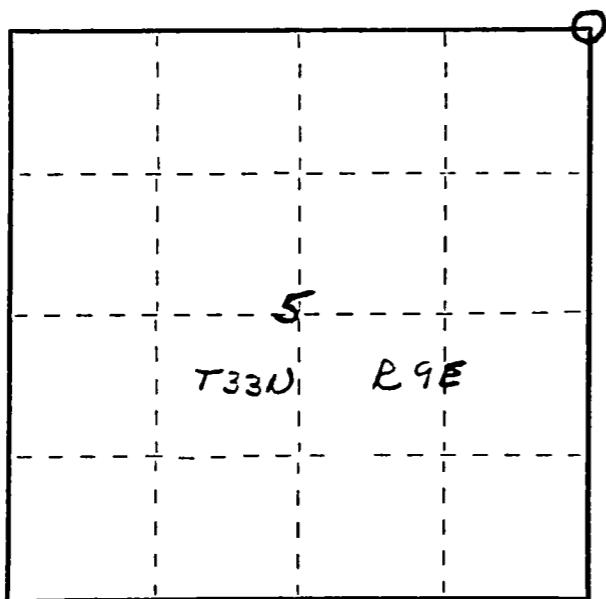

○ = Corner monument restored.

Dated at ANTIGO, Wis., this 21 day of MARCH, 1981.

Signature Raymond J. Hallisy Title REG. LAND SURVEYOR Registration No. 5-685
(County Surveyor, Registered Land Surveyor, or other duly authorized official)

Office of Register of Deeds, County of _____, I hereby certify that the within instrument was filed in this office for record on the _____ day of _____, 19____ at _____ o'clock _____ M.

(Register of Deeds)

By _____ Deputy