

CERTIFIED LAND CORNER RESTORATION

Index No. T-9
34-7

State of Wisconsin }
County of Lancaster } ss.

I, Raymond J. Hallisy, do hereby
certify that on the 30th day
of October, 1977, I found
evidence of the 1/4
28 & 29
corner of 34
Township 9E, North, Range
9E, Fourth Principal Meridian,
as described hereon; and that from this evidence
I established a new monument and accessories
as described hereon to perpetuate the original
location of this corner.

Resident witnesses:

.....
.....
.....

History of original corner establishment:

Corner set in the 1930 resurvey.

Description of corner evidence found:

4" iron pipe with brass cap with wood post laying alongside.
Old BT - 12" Cedar N51E 12 Links.

Description of monument and accessories I established to perpetuate the original location of this corner.

New BTs

10" Red Maple N28W 20' 1"
9" Cedar N4E 24' 3"
6" Hemlock S9E 23' 6"

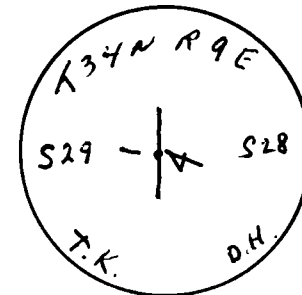

FORM 985 H. C. MILLER CO., MILWAUKEE

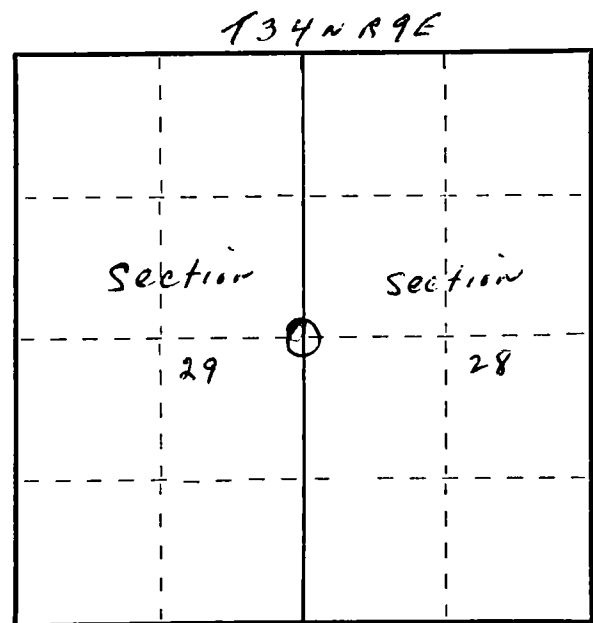

○ = Corner monument restored.

Dated at Antiro, Wis., this 30th day of October, 1977.

Signature Raymond J. Hallisy Title Land Surveyor Registration No. S685
(County Surveyor, Registered Land Surveyor, or other duly authorized official)

Office of Register of Deeds, County of _____, I hereby certify that the within
instrument was filed in this office for record on the _____ day of _____, 19____
at _____ o'clock _____ M.

.....
(Register of Deeds)

By _____ Deputy