

CERTIFIED LAND CORNER RESTORATION

Index No. U-9
34-9

State of Wisconsin }
County of Langlade } ss.

I Raymond J. Hallisy, do hereby
certify that on the 30th day
of October, 1977, I found
evidence of the S 1/16
corner of 28 & 29
Township 34, North, Range
9E, Fourth Principal Meridian,
as described hereon; and that from this evidence
I established a new monument and accessories
as described hereon to perpetuate the original
location of this corner.

History of original corner establishment:

Corner set in the 1930's

Description of corner evidence found:

Found wood stake standing, marked 1/89

Resident witnesses:

.....
.....
.....

Description of monument and accessories I established to perpetuate the original location of this corner.

Set 1 1/2" iron pipe with brass cap alongside wood post.

New PT's

6" Red Maple S87F 9.7 Ft.
4" Hemlock N7E 13.3 Ft.

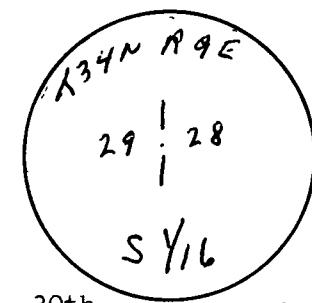

FORM 985 R. C. MILLER CO. MILWAUKEE

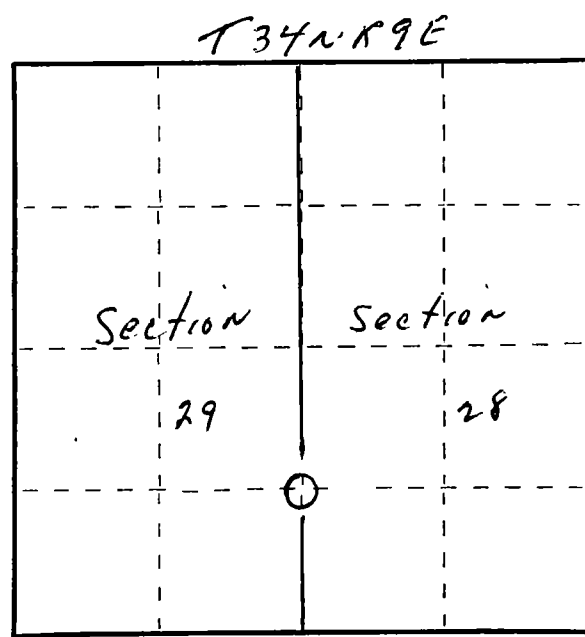

○ = Corner monument restored.

Dated at Antigo, Wis., this 30th day of October, 1977.

Signature Raymond J. Hallisy Title Land Surveyor Registration No. 5685
(County Surveyor, Registered Land Surveyor, or other duly authorized official)

Office of Register of Deeds, County of _____, I hereby certify that the within
instrument was filed in this office for record on the _____ day of _____, 19____
at _____ o'clock _____ M.

.....
(Register of Deeds)

By _____ Deputy