

CERTIFIED LAND CORNER RESTORATION

Index No. T-1

34-10

State of Wisconsin }
County of Lodge } ss.

I, Raymond J. Hallisy, do hereby certify that on the 7th day of April, 1979, I found evidence of the 1/4 corner of Section 25 & 30 Township 34, North, Range 9E & 10E, Fourth Principal Meridian, as described hereon; and that from this evidence I established a new monument and accessories as described hereon to perpetuate the original location of this corner.

Resident witnesses:

.....
.....
.....

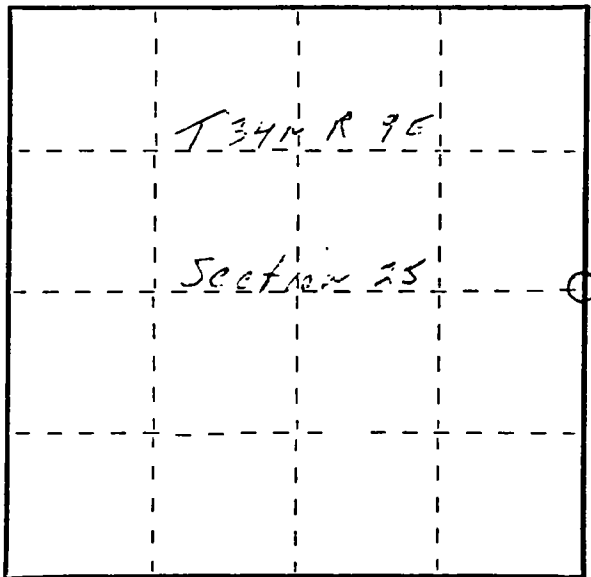

○ = Corner monument restored.

History of original corner establishment:

Corner set in the 1930 resurvey.

Description of corner evidence found:

4" brass cap

12" Hemlock S12W 16 links (dead)

Description of monument and accessories I established to perpetuate the original location of this corner.

New ET's

6" Hard Maple N11W 16 links

9" Hard Maple 90E 26.5 links

9" Red Maple S56W 10.2 links

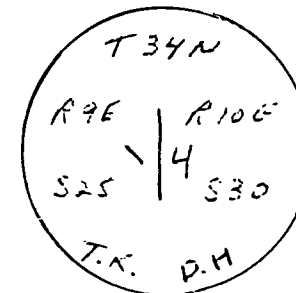

Dated at Antigo, Wis., this 7th day of April, 1979.

Signature Raymond J. Hallisy Title Reg. Surveyor Registration No. S-685
(County Surveyor, Registered Land Surveyor, or other duly authorized official)

Office of Register of Deeds, County of Lodge, I hereby certify that the within instrument was filed in this office for record on the 7th day of April, 1979 at 10:00 o'clock A.M.

.....
(Register of Deeds)

By..... Deputy

FORM 5075 H. C. MILLER CO. MILWAUKEE