

CERTIFIED LAND CORNER RESTORATION

34-9
Index No. R-22

State of Wisconsin }
County of Langlade } ss.

History of original corner establishment:

Corner set in the 1930's by: T. H. Kilroe
D. A. Hintz

I, Raymond J. Hallisy, do hereby certify that on the 25th day of May, 1968, I found evidence of the W 1/16 corner of Section 25 Township 34, North, Range 9, Fourth, Principal Meridian, as described hereon; and that from this evidence I established a new monument and accessories as described hereon to perpetuate the original location of this corner.

Description of corner evidence found:

Found squared stake in swamp - top bad bottom good.
Stake marked W 1/8 S24 S25

Resident witnesses:

Description of monument and accessories I established to perpetuate the original location of this corner.

Set Std. 1 1/2" pipe with cap marked W 1/16

6" SPRUCE NO° 10' 6"
SCRIBED BT

IP → ○

8" SPRUCE S32°E 18'
SCRIBED BT

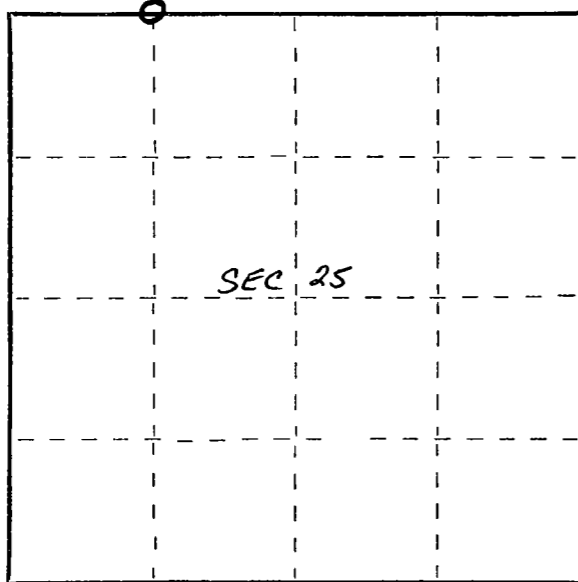

Dated at Antigo, Wis., this 25th day of May, 1968

Signature Raymond J. Hallisy Title Reg Land Surveyor Registration No. 685
(County Surveyor, Registered Land Surveyor, or other duly authorized official)

Office of Register of Deeds, County of _____, I hereby certify that the within instrument was filed in this office for record on the _____ day of _____, 19____ at _____ o'clock _____ M.

(Register of Deeds)

By _____ Deputy

○ = Corner monument restored.