

CERTIFIED LAND CORNER RESTORATION

34-9  
Index No. 0-21

State of Wisconsin }  
County of Langlade } ss.

History of original corner establishment:  
Corner set in the 1930 resurvey

I Raymond J. Hallisy do hereby certify that on the 5th day of October, 1969, I found evidence of the N 1/16 corner of Section 23 Township T34, North, Range 9E, Fourth, Principal Meridian, as described hereon; and that from this evidence I established a new monument and accessories as described hereon to perpetuate the original location of this corner.

Description of corner evidence found:  
Found old stake down, point intact, marked 1/8 S

Resident witnesses:  
\_\_\_\_\_  
\_\_\_\_\_  
\_\_\_\_\_

Description of monument and accessories I established to perpetuate the original location of this corner.

Set 2" pipe with brass cap  
B.T.'s to corner  
Hard Maple 8" S22E 17.1 Ft.  
Hard Maple 7" S42W 8.5 Ft.  
B.T.'s faced at base of tree and scribed BT

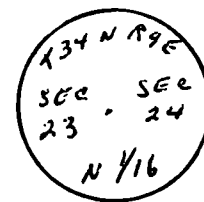

FORM 985 H. C. MILLER CO., MILWAUKEE

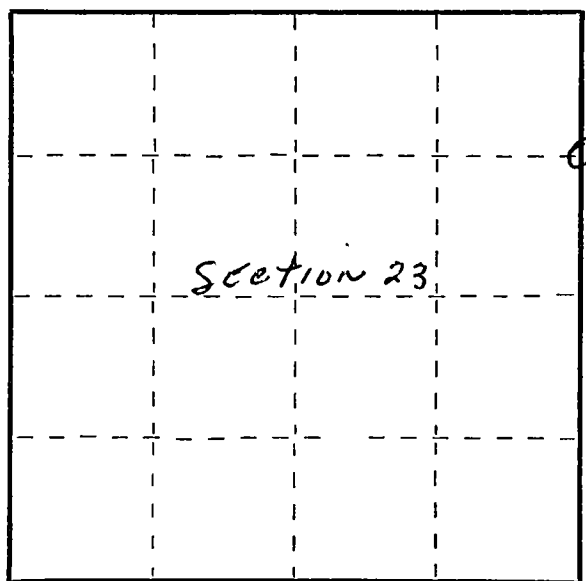

○ = Corner monument restored.

Dated at Antigo, Wis., this 5th day of October, 1969.

Signature Raymond J. Hallisy Title Reg. Land Surveyor Registration No. S-685  
(County Surveyor, Registered Land Surveyor, or other duly authorized official)

Office of Register of Deeds, County of \_\_\_\_\_, I hereby certify that the within instrument was filed in this office for record on the \_\_\_\_\_ day of \_\_\_\_\_, 19\_\_\_\_ at \_\_\_\_\_ o'clock \_\_\_\_\_ M.

\_\_\_\_\_  
(Register of Deeds)

By \_\_\_\_\_ Deputy