

CERTIFIED LAND CORNER RESTORATION

Index No. R-18

State of Wisconsin }
County of Lafayette } ss.

I Raymond J. Hallisy, do hereby certify that on the 5th day of Sept, 1987, I found evidence of the W 1/16 corner of Section 26 Township 34, North, Range 9E, Fourth Principal Meridian, as described hereon; and that from this evidence I established a new monument and accessories as described hereon to perpetuate the original location of this corner.

Resident witnesses:

.....
.....
.....

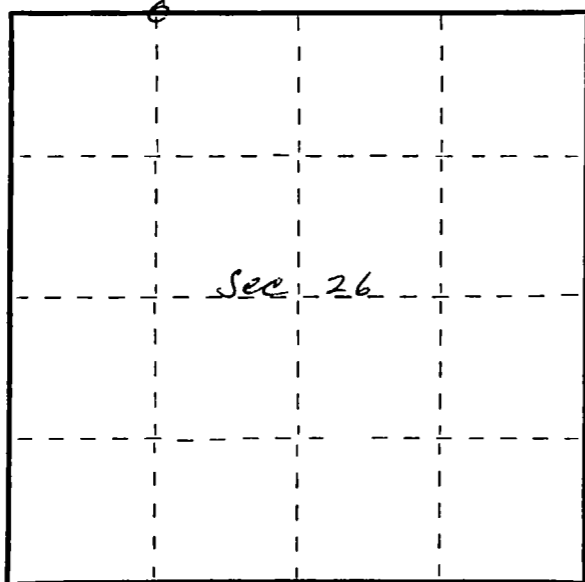

○ = Corner monument restored.

History of original corner establishment:

1930 RESURVEY

Description of corner evidence found:

1 1/2" iron pipe
MARKED

14" BALSAM N54W 12' (DYING)
12" ASPEN S76E 2' (DYING)



Description of monument and accessories I established to perpetuate the original location of this corner.

NEW BT'S

8" Red MAPLE N0° 24.5'
4" Red MAPLE S32°E 14.6'

Dated at Antigo, Wis., this 5th day of Sept, 1987.

Signature Raymond J. Hallisy Title SURVEYOR Registration No. 5-685
(County Surveyor, Registered Land Surveyor, or other duly authorized official)

Office of Register of Deeds, County of....., I hereby certify that the within instrument was filed in this office for record on the..... day of....., 19..... at..... o'clock..... M.

.....
(Register of Deeds)

By..... Deputy

FORM 985 M. E. MILLER CO., MILWAUKEE

CERTIFIED LAND CORNER RESTORATION

34-9
Index No. R-18

State of Wisconsin }
County of Lanlade } ss.

History of original corner establishment:

Corner set in the 1930's by; T. H. Kilroe
D. A. Hintz

I, Raymond J. Hallisy, do hereby certify that on the 25th day of May, 1968, I found evidence of the W 1/16 corner of Section 26 Township 34, North, Range 9, Fourth, Principal Meridian, as described hereon; and that from this evidence I established a new monument and accessories as described hereon to perpetuate the original location of this corner.

Description of corner evidence found:
Found squared stake down, point intact
Stake marked W 1/8 S26 S23

Resident witnesses:

Description of monument and accessories I established to perpetuate the original location of this corner.
Set Std. 1 1/2" pipe with cap marked W 1/16

FORM 985 H. C. MILLER CO. MILWAUKEE

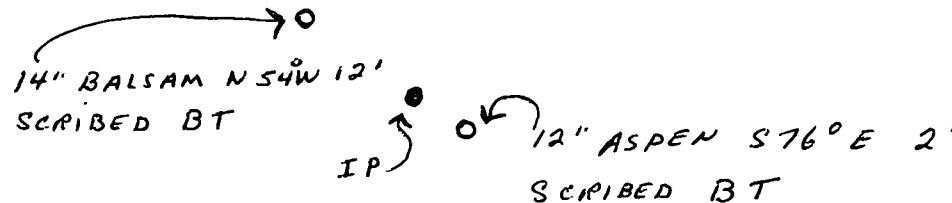
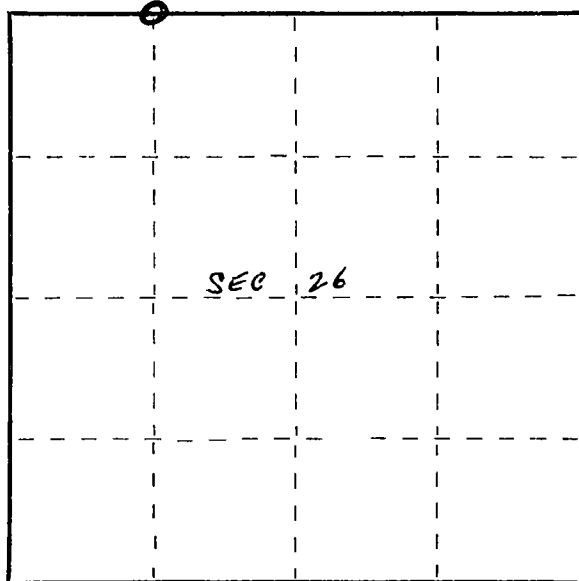

Dated at Antigo, Wis., this 25th day of May, 1968

Signature Raymond J. Hallisy Title Reg. Land Surveyor Registration No. 1-685
(County Surveyor, Registered Land Surveyor, or other duly authorized official)

Office of Register of Deeds, County of _____, I hereby certify that the within instrument was filed in this office for record on the _____ day of _____, 19____ at _____ o'clock _____ M.

(Register of Deeds)

By _____ Deputy

○ = Corner monument restored.