

CERTIFIED LAND CORNER RESTORATION

Index No. R-7

A340920 0020

FORM 985 H. C. MILLER CO., MILWAUKEE

State of Wisconsin }  
County of LANGLADE } ss.

History of original corner establishment:

1930 RESURVEY

I Raymond J. Hallisy, do hereby certify that on the 5<sup>TH</sup> day of Sept, 1987, I found evidence of the Y4 corner of Section 20 S 29 Township 34, North, Range 9E, Fourth Principal Meridian, as described hereon; and that from this evidence I established a new monument and accessories as described hereon to perpetuate the original location of this corner.

Description of corner evidence found:

BRASS CAP MARKED

WITNESS TREES

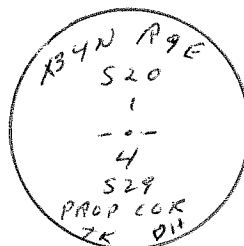

6" Red Maple S80N 16.25' (DYING)  
6" HARD MAPLE N86°30'E 11.35'  
8" HARD MAPLE S25 E 12.55'

Resident witnesses:

.....  
.....  
.....

Description of monument and accessories I established to perpetuate the original location of this corner.

NEW BT

12" HARD MAPLE N43W 34.2 FT.

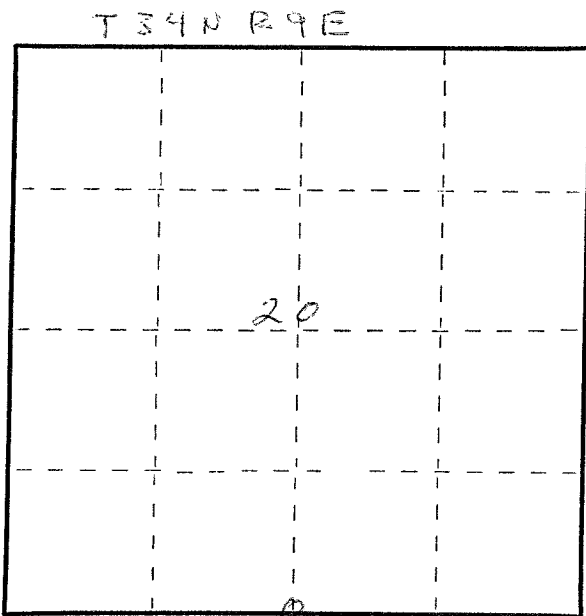

Dated at ANTIGO, Wis., this 5<sup>TH</sup> day of Sept, 1987.

Signature Raymond J. Hallisy Title S-685-SURVEYOR Registration No. S-685  
(County Surveyor, Registered Land Surveyor, or other duly authorized official)

Office of Register of Deeds, County of....., I hereby certify that the within instrument was filed in this office for record on the..... day of....., 19..... at..... o'clock..... M.

.....  
(Register of Deeds)

By..... Deputy

○ = Corner monument restored.