

X

4340917 3000 1968

FORM 985 H. C. MILLER CO., MILWAUKEE, WIS.

State of Wisconsin }
County of Langlade } ss.

I, Raymond J. Hallisy, do hereby certify that on the 10th day of June, 1968, I found evidence of the N 1/16 corner of Section 17 Township 34, North, Range 9, Fourth, Principal Meridian, as described hereon; and that from this evidence I established a new monument and accessories as described hereon to perpetuate the original location of this corner.

Resident witnesses:
.....
.....
.....

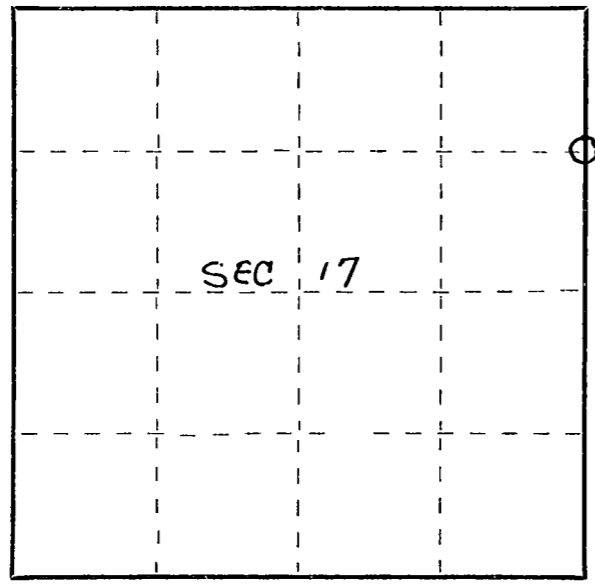

○ = Corner monument restored.

CERTIFIED LAND CORNER RESTORATION

34-9
Index No. K-9

History of original corner establishment:

Corner set in the 1930's by: T.H. Kilroe
D.A. Hintz

Description of corner evidence found:

**Found squared stake with 1" pipe along side, stake down.
Marked 1/8 Cor 30 Ft. S.**

Description of monument and accessories I established to perpetuate the original location of this corner.
**Set Std. 1 1/2" pipe with cap marked W.C. C. 30 FT. S. N 1/16
BT, S TO W.C.**

*11" TAMARACK SCRIBED BT
N42W 59'*

*7" RED MAPLE SCRIBED BT
← N22°E 25' 8"*

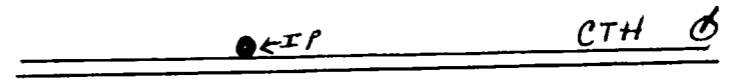

Dated at Adriago, Wis., this 10th day of June, 1968

Signature Raymond J. Hallisy Title Reg Land Surveyor Registration No. A-685
(County Surveyor, Registered Land Surveyor, or other duly authorized official)

Office of Register of Deeds, County of _____, I hereby certify that the within instrument was filed in this office for record on the _____ day of _____, 19____ at _____ o'clock _____ M.

(Register of Deeds)

By _____ Deputy