

4340917 0030 1976

FORM 985 H. C. MILLER CO., MILWAUKEE

CERTIFIED LAND CORNER RESTORATION

Index No. N-6

State of Wisconsin }
County of Lan glade } ss.

I, Raymond S. Hallisy, do hereby certify that on the 11 th day of May, 1976, I found evidence of the W 1/4 corner of Section 17 & 20 Township 34, North, Range 9E, Fourth Principal Meridian, as described hereon; and that from this evidence I established a new monument and accessories as described hereon to perpetuate the original location of this corner.

Resident witnesses:
.....
.....
.....

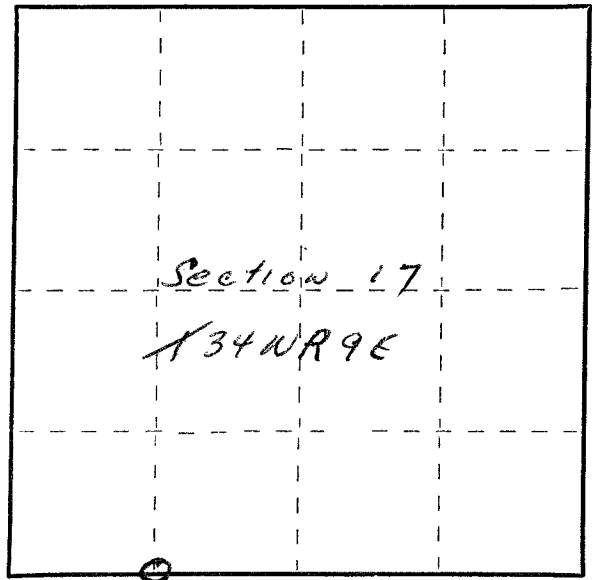

○ = Corner monument restored.

History of original corner establishment:

Corner set in 1930 Resurvey.
Restored 6/10/68

Description of corner evidence found:

Corner destroyed by Hiway Dept
Light pole BT S64E 100' 6"

Description of monument and accessories I established to perpetuate the original location of this corner.

Set 1 1/2" pipes with Brass Caps marked



Dated at Antigo, Wis., this 11th day of May, 1976.

Signature Raymond S. Hallisy Title Reg Land Surveyor Registration No.
(County Surveyor, Registered Land Surveyor, or other duly authorized official)

Office of Register of Deeds, County of, I hereby certify that the within instrument was filed in this office for record on the day of, 19..... at o'clock M.

.....
(Register of Deeds)
By Deputy