

CERTIFIED LAND CORNER RESTORATION

Index No. E-11

State of Wisconsin }  
County of Lan glade } ss.

I, Raymond J. Hallsy, do hereby certify that on the 27th day of December, 1980, I found evidence of the 1/4 corner of Section 4 & 9 Township 34, North, Range 9E, Fourth Principal Meridian, as described hereon; and that from this evidence I established a new monument and accessories as described hereon to perpetuate the original location of this corner.

Resident witnesses:

.....  
.....  
.....

FORM 985 K. C. MILLER CO., MILWAUKEE

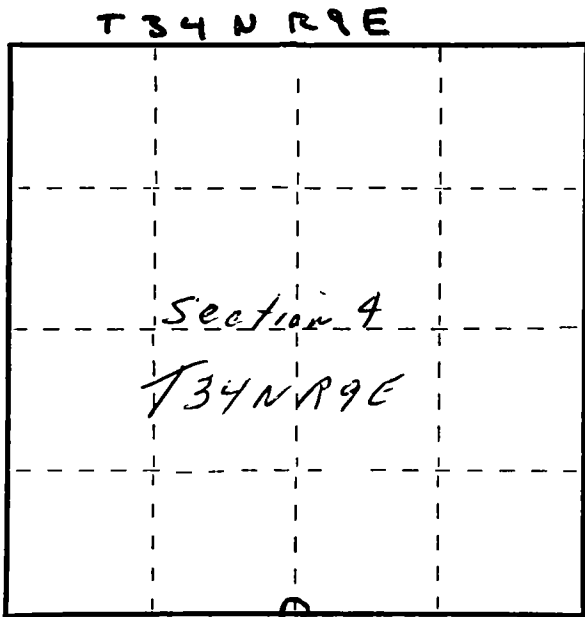

○ = Corner monument restored.

History of original corner establishment:

Corner set in the 1930 resurvey.

Description of corner evidence found:

4" pipe with brass cap.

Description of monument and accessories I established to perpetuate the original location of this corner.

New BT's

- 8" Tamarack N79W 19'10"
- 10" Hemlock N36W 27'1"
- 5" Tamarack N6E 13'3"

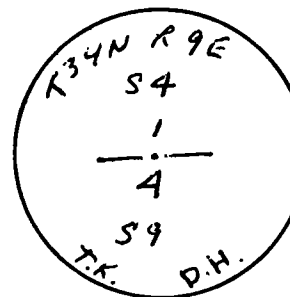

Dated at Antigo, Wis., this 27th day of December, 1980

Signature Raymond J. Hallsy Title Reg. surveyor Registration No. S-685  
(County Surveyor, Registered Land Surveyor, or other duly authorized official)

Office of Register of Deeds, County of....., I hereby certify that the within instrument was filed in this office for record on the..... day of....., 19..... at..... o'clock..... M.

.....  
(Register of Deeds)

By.....Deputy