

# U. S. PUBLIC LAND SURVEY MONUMENT RECORD

**INSTRUCTIONS:**

This record shall show the location of the corner and shall include all of the following nine elements (a through i).

- (a) Identify the corner by reference to the U.S. public land survey system.  
 ○ = Corner monument restored.

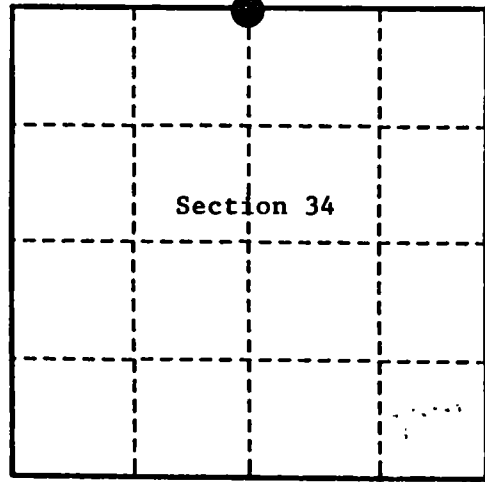

Quarter Corner between Sections 27 and 34,  
 T33N. R14E., Langlade County, Wisconsin.

State Plane Coordinates, Wisconsin Central Zone

N - 539436.78  
 E - 2295190.53

Geographic Coordinates

N - 45-18-21.514  
 W - 88-43-48.847

- (b) Describe any record evidence, monument evidence, occupational evidence, testimonial evidence or any other material evidence you considered, and whether the monument was found or placed.

Original survey in 1865 by J.L. Nowlin. West between Sections 27 and 34, at 40.00 chains set wood post and made the following bearing trees: Birch, 12", N.05°E., 20 links (13.20 feet), Sugar, 8", S.35°W., 35 links (23.10 feet).

In 1996, Alan Harrison, RLS, located the corner search area using G.P.S. control. No corner evidence was recovered. Reestablished the corner position at proportionate distance and on line between the Northeast and Northwest Section corners of Section 34. At the corner position, set a 2½" X 36" aluminum pipe monument with an aluminum cap stamped to identify the corner. Blazed and scribed new bearing trees as noted below.

- (c) In the plan view drawing below, provide reference ties to at least 4 witness monuments, or, if the location is within a municipality, to at least 2 witness monuments. (witness monuments shall be made of concrete, natural stone, iron or other equally durable material.)

- (d) Show a plan view drawing depicting the relevant monuments and reference ties which is sufficient in detail to enable accurate relocation of the corner monument if the corner monument is disturbed. Indicate north.

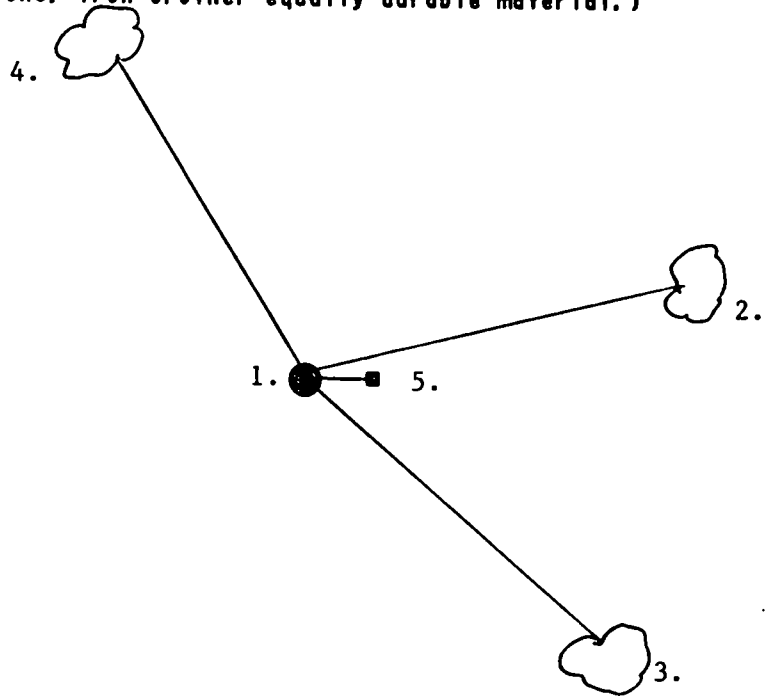

1. 2½" X 36" aluminum monument stamped to identify corner.
2. Sugar, 5", N.63°E., 18.09 feet.
3. Sugar, 5", S.52°E., 25.39 feet.
4. Sugar, 8", N.45°W., 17.62 feet.
5. Steel Sign Post, East, 1.00 feet.

(e) Describe any material discrepancy between the location of the corner as restored or reestablished and the location of that corner as previously restored or reestablished by distance and direction. Show the discrepancy on the plan view drawing under (d). above. Show the distances between the corner as previously restored or reestablished and (1) the corner as restored or reestablished, and (2) to at least 2 of the witness monuments shown on the drawing in (d), above.

None

(f) Was the corner restored through acceptance of (1) an obliterated evidence location, or, (2) a found perpetuated location?

No

(g & h) Was the corner reestablished through lost corner proportionate methods? If so, show the method, including the directions and distances to other public land survey corners used as evidence or used for proportioning in determining the corner location?

Yes

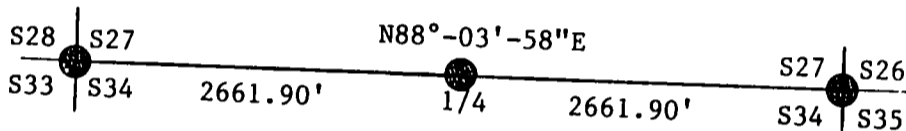

(1) I, Alan D. Harrison  
 (type or print name) certify that the corner location shown on this record was determined by me or under my direction and control and that this U.S. Public Land Survey Monument Record is correct and complete to the best of my knowledge and belief.

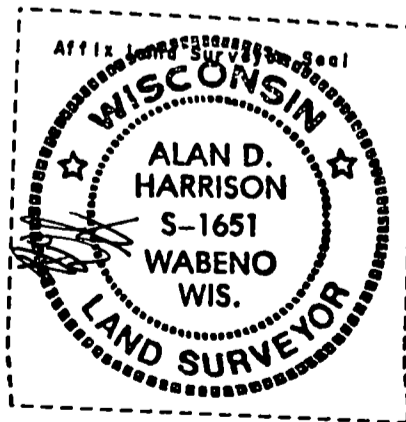

Signature

Date

CERTIFICATE READY FOR FILING:

Jerry S. Strubbe  
 District Ranger