

CERTIFIED LAND CORNER RESTORATION

32-13

Index No. A-2.1

State of Wisconsin }
County of LANGLADE } ss.

History of original corner establishment:
CORNER SET BY HUTCHINSON CIRCA 1939.

I, ROBERT J. POSS, do hereby certify that on the 29TH day of JULY, 1971, I found evidence of the SECTION corner of SECS. 35, 36, 1, 2 Township 33N. & 32N., North, Range 13 EAST, Fourth, Principal Meridian, as described hereon; and that from this evidence I established a new monument and accessories as described hereon to perpetuate the original location of this corner.

Description of corner evidence found:

1/4" WELL POINT IN ROCK PILE

Resident witnesses:

WM WOLF (IN CHRM.)

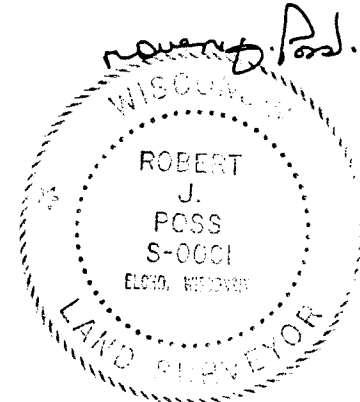

Description of monument and accessories I established to perpetuate the original location of this corner.

SET BRASS CAPPED 2" IRON PIPE MKD T 33 N

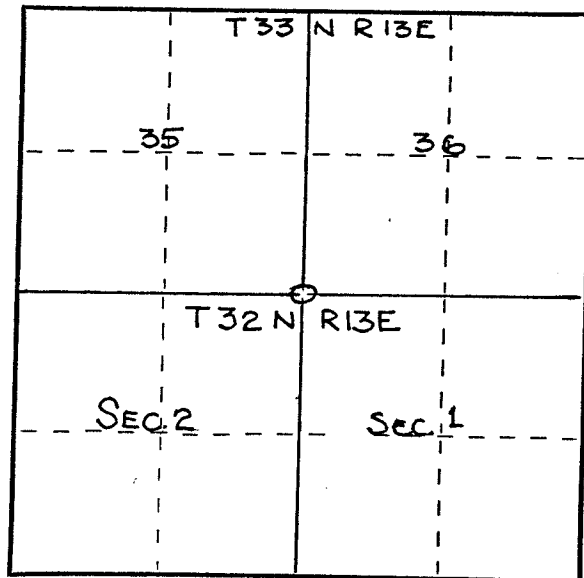

- 2 (3)
1 (3) 0
4 (3) 3 (3)
- 1: HD. MAPLE 16 S85W 17.1
 - 2: HD. MAPLE 16 N23 1/2 E 7.6
 - 3: Y. BIRCH 6 #2 S25E 16.0 (IN PINE STUMP)
 - 4: BASSWOOD 6" S47W 28.7
- 1, 2, 4 - BLAZED & SCRIBED NBT.
- | | |
|---------|------|
| SEC. 35 | S 36 |
| S 2 | S 1 |
| T 32 N | |
| R-13E | |

Dated at ELCHO, Wis., this 29TH day of JULY, 1971.

Signature _____ Title _____ Registration No. _____
(County Surveyor, Registered Land Surveyor, or other duly authorized official)

Office of Register of Deeds, County of _____, I hereby certify that the within instrument was filed in this office for record on the _____ day of _____, 19____ at _____ o'clock _____ M.

(Register of Deeds)

By _____ Deputy

○ = Corner monument restored.

