

CERTIFIED LAND CORNER RESTORATION

33-13

Index No. X-7

State of Wisconsin }
County of LANGLADE } ss.

I RAYMOND J. HALLISY do hereby certify that on the 3rd day of JULY, 19 71, I found evidence of the CENTER 1/4 corner of SECTION 32 Township 33, North, Range 13E, Fourth, Principal Meridian, as described hereon; and that from this evidence I established a new monument and accessories as described hereon to perpetuate the original location of this corner.

Resident witnesses:

.....
.....
.....

History of original corner establishment:

OWENS - ILLINOIS SURVEY

Description of corner evidence found:

WOOD POST SCRIBED S 32, C 1/4
1 1/2" well point ALONG SIDE

Description of monument and accessories I established to perpetuate the original location of this corner.

SET 4" IRON PIPE WITH 4" BRASS CAP IN CEMENT
ROCK MOUND
NEW BT, S
HARD MAPLE 5" 559W 32.3 LKS
" " 5" 517W 28.6 LKS



FORM 985 H. C. MILLER CO., MILWAUKEE

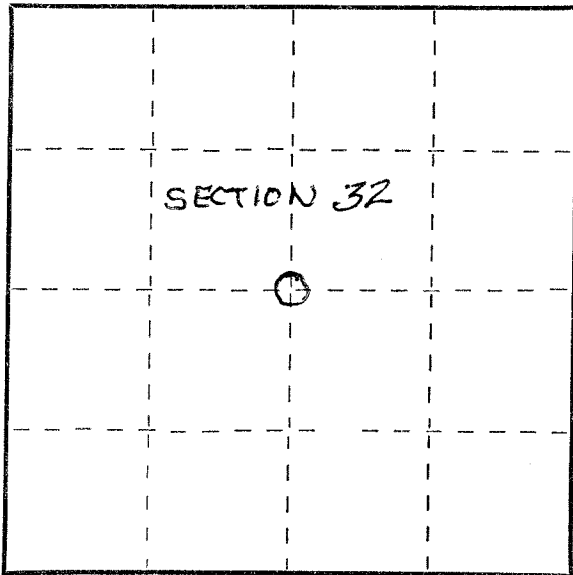

○ = Corner monument restored.

Dated at Antigo, Wis., this 3rd day of JULY, 19 71

Signature R. J. Hallisy Title REG. LAND SURVEYOR Registration No. 685
(County Surveyor, Registered Land Surveyor, or other duly authorized official)

Office of Register of Deeds, County of _____, I hereby certify that the within instrument was filed in this office for record on the _____ day of _____, 19 _____ at _____ o'clock _____ M.

.....
(Register of Deeds)
By _____ Deputy