

32-13

Index No. A-5

CERTIFIED LAND CORNER RESTORATION

State of Wisconsin }
County of LANGLADE } ss.

History of original corner establishment:

I RAYMOND J. HALLISY, do hereby certify that on the 3rd day of JULY, 19 71, I found evidence of the SECTION corner of 31, 32, 5, 6 Township 32 + 33, North, Range 13E, Fourth, Principal Meridian, as described hereon; and that from this evidence I established a new monument and accessories as described hereon to perpetuate the original location of this corner.

Description of corner evidence found:
ROCK MOUND, WOOD POST SCRIBED 55, 56, 531, 532
1/4" IRON PIPE ALONGSIDE
OLD WOOD POST DOWN SCRIBED 56

Resident witnesses:

Description of monument and accessories I established to perpetuate the original location of this corner.

SET 4" BRASS CAP IN CEMENT
ROCK MOUND
NEW BT,
HARD MAPLE 11" N51° 20 FT
" " 12" S12°E 37.7 FT
BT'S FACED AT BASE OF TREE & SCRIBED BT.

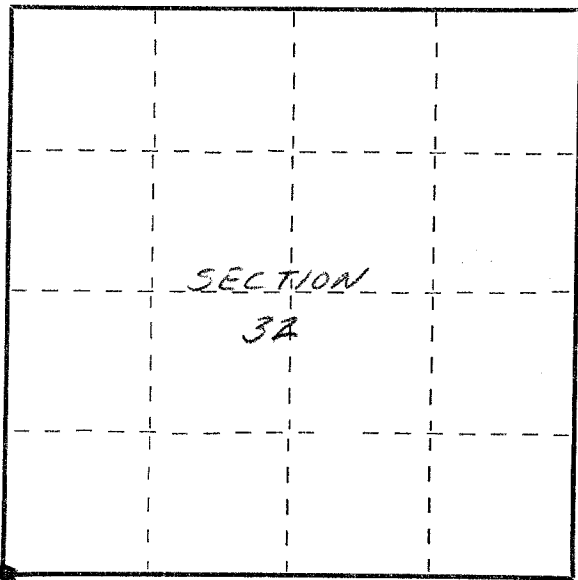
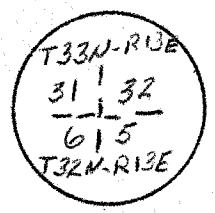

Dated at Antigo, Wis., this 3rd day of July, 19 71.

Signature R J H Title Reg. LAND SURVEYOR Registration No. 685
(County Surveyor, Registered Land Surveyor, or other duly authorized official)

Office of Register of Deeds, County of _____, I hereby certify that the within instrument was filed in this office for record on the _____ day of _____, 19 _____ at _____ o'clock _____ M.

(Register of Deeds)
By _____ Deputy

○ = Corner monument restored.

FORM 985 M. C. MILLER CO., MILWAUKEE