

CERTIFIED LAND CORNER RESTORATION

33-13

Index No. 1-6

State of Wisconsin }
County of Langlade } ss.

I, Raymond J. Hallisy, do hereby certify that on the 12th day of June, 1971, I found evidence of the W 1/16 corner of 29 & 32 Township 33, North, Range 13E, Fourth, Principal Meridian, as described hereon; and that from this evidence I established a new monument and accessories as described hereon to perpetuate the original location of this corner.

Resident witnesses:

History of original corner establishment:

Owens- Illinois survey

Description of corner evidence found:

Found squared stake 3/4" iron pipe and old BT's

12" Red maple S46E 10'8"
10" Red maple S46W 2'3"

Description of monument and accessories I established to perpetuate the original location of this corner.

Set 2" pipe with brass cap, rock mound

BT's to corner
Yellow Birch N56E 18 Feet 6 inches
Red Maple N78W 10 Feet 4 inches
BT's faced at base of tree and scribed BT

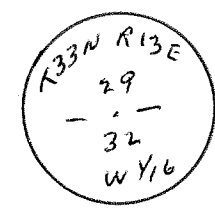

FORM 985 H. C. MILLER CO., MILWAUKEE

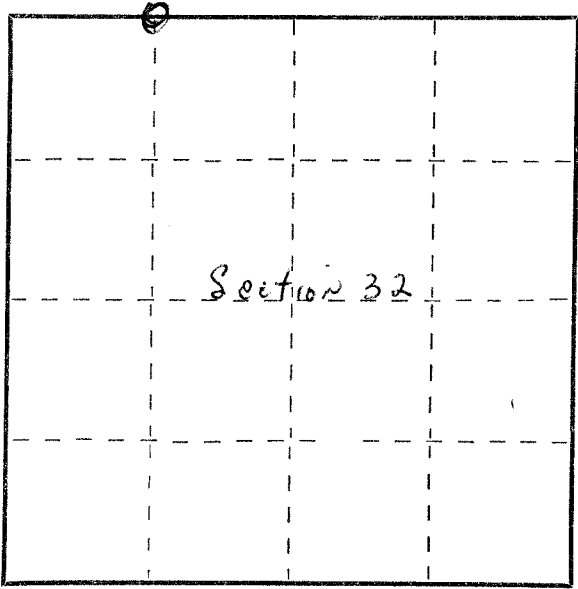

○ = Corner monument restored.

Dated at Antigo, Wis., this 12th day of June, 1971

Signature R. J. Hallisy Title Reg. Land Surveyor Registration No. 1685
(County Surveyor, Registered Land Surveyor, or other duly authorized official)

Office of Register of Deeds, County of _____, I hereby certify that the within instrument was filed in this office for record on the _____ day of _____, 19____ at _____ o'clock _____ M.

(Register of Deeds)
By _____ Deputy