

CERTIFIED LAND CORNER RESTORATION

Index No. E-1

33-14

State of Wisconsin }  
County of LANGLADE } ss.

I WILLIAM F. KELLY, do hereby certify that on the 30TH day of MARCH, 1979, I found evidence of the SE corner of SECTION 1 Township 33, North, Range 13 E, Fourth Principal Meridian, as described hereon; and that from this evidence I established a new monument and accessories as described hereon to perpetuate the original location of this corner.

Resident witnesses:

.....  
.....  
.....

FORM 903 W. C. MILLER CO., MILWAUKEE

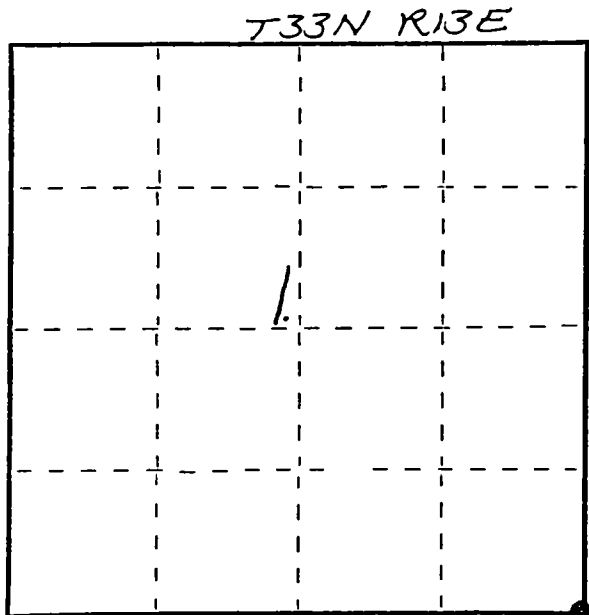

○ = Corner monument restored.

History of original corner establishment:

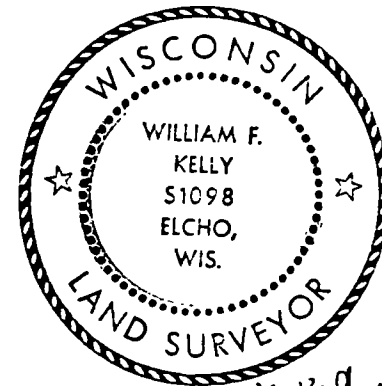

*William F. Kelly*

Description of corner evidence found:

FOUND 4" X 4" CEDAR POST ON FENCE LINE

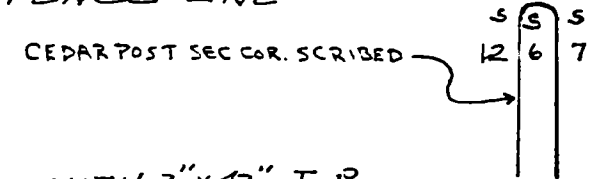

REMONUMENTED SE SEC COR, SEC. 1, WITH 2" X 42" I.P. WITH BRASS CAP & SCRIBED NEW B.T.'S.

Description of monument and accessories I established to perpetuate the original location of this corner.

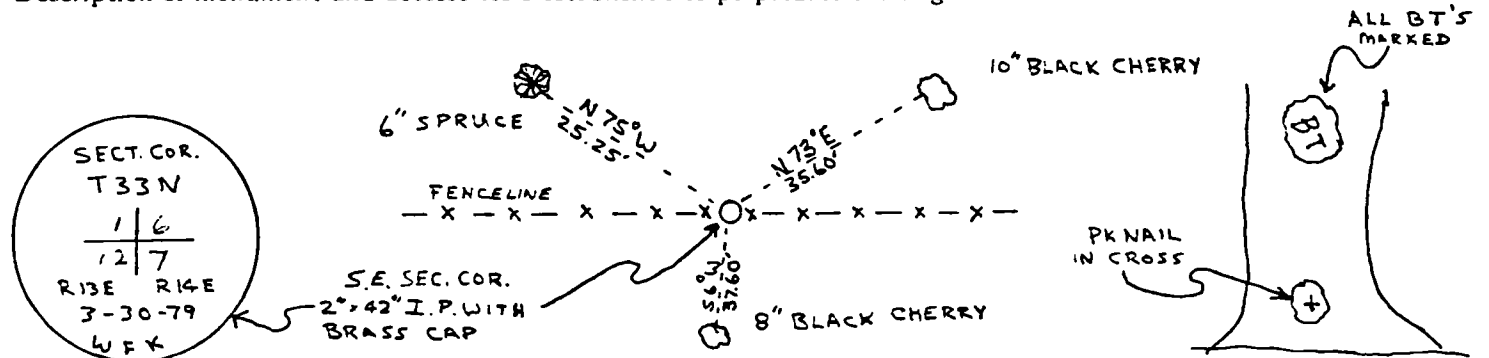

Dated at ELCHO, Wis., this 30TH day of MARCH, 1979.

Signature William F. Kelly Title COUNTY SURVEYOR Registration No. 5-1098  
(County Surveyor, Registered Land Surveyor, or other duly authorized official)

Office of Register of Deeds, County of....., I hereby certify that the within instrument was filed in this office for record on the..... day of....., 19..... at..... o'clock..... M.

.....  
(Register of Deeds)  
By..... Deputy