

CERTIFIED LAND CORNER RESTORATION

Index No. A-23

State of Wisconsin }
County of LAWGLADE } ss.

History of original corner establishment:

CORNER SET IN THE 1930 RESURVEY

I RAYMOND J. HALLISY, do hereby certify that on the 3RD day of July, 1987, I found evidence of the Y4 corner of SECTION 36 & 1 Township 32 E 33, North, Range 12 E, Fourth Principal Meridian, as described hereon; and that from this evidence I established a new monument and accessories as described hereon to perpetuate the original location of this corner.

Description of corner evidence found:

4" IRON PIPE WITH BRASS CAP
X ON ROCK N40°W 8'10" MARKED

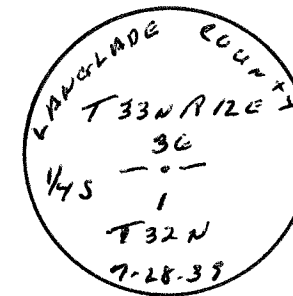

Resident witnesses:

Description of monument and accessories I established to perpetuate the original location of this corner.

NEW BT'S

12" BASSWOOD N72W 5'1"
7" HARD MAPLE N32E 11'1"
6" HARD MAPLE N80E 18'11"
8" HARD MAPLE S2E 21'9"

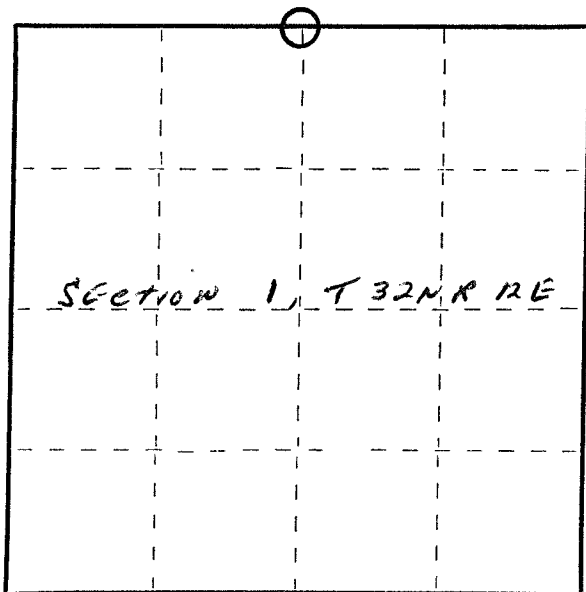

○ = Corner monument restored.

Dated at Antigo, Wis., this 3RD day of July, 1987.

Signature Raymond J. Hallisy Title SURVEYOR Registration No. 5685
(County Surveyor, Registered Land Surveyor, or other duly authorized official)

Office of Register of Deeds, County of _____, I hereby certify that the within instrument was filed in this office for record on the _____ day of _____, 19____ at _____ o'clock _____ M.

(Register of Deeds)

By _____ Deputy