

CERTIFIED LAND CORNER RESTORATION

Index No. X-17

State of Wisconsin }  
County of LANGLADE } ss.

History of original corner establishment:  
CORNER SET IN RESURVEY OF TOWNSHIP IN 1939.

I WILLIAM F. KELLY, do hereby certify that on the 6<sup>TH</sup> day of AUGUST, 1976, I found evidence of the EAST 1/4 SECTION corner of SECT Township 33, North, Range 12E, Fourth Principal Meridian, as described hereon; and that from this evidence I established a new monument and accessories as described hereon to perpetuate the original location of this corner.

Resident witnesses:

.....  
.....  
.....

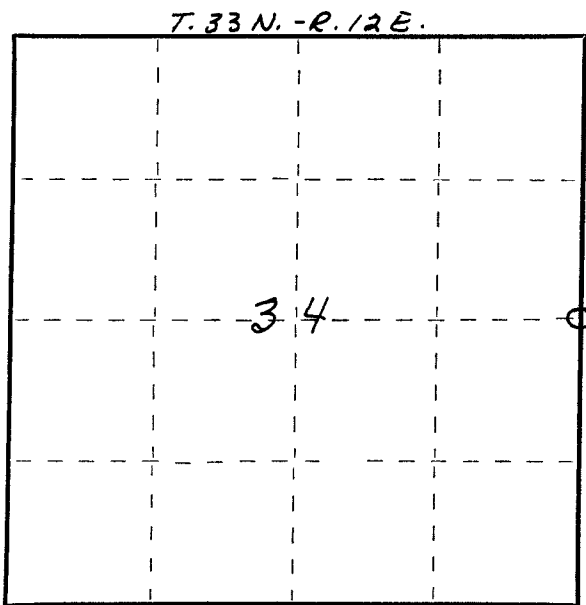

○ = Corner monument restored.

Description of corner evidence found:

4" PIPE SET IN CONCRETE WITH 4" BRASS CAP.  
CAP MARKED:

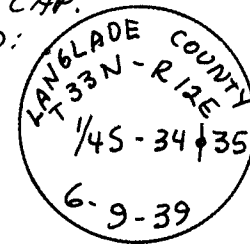
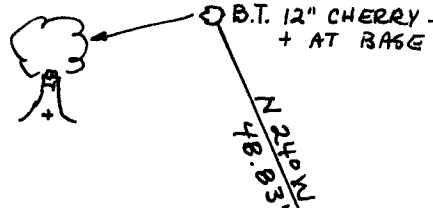

*William F. Kelly*

Description of monument and accessories I established to perpetuate the original location of this corner.

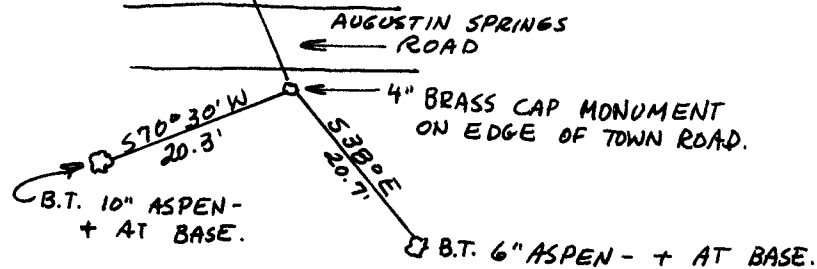

MARKED NEW WITNESS TREES AND SET STONES AROUND MONUMENT.

SEE 2008 UPDATE ON REVERSE SIDE

Dated at ELCHO, Wis., this 6<sup>TH</sup> day of AUGUST, 1976.

Signature William F. Kelly Title REGISTERED LAND SURVEYOR Registration No. 51098  
(County Surveyor, Registered Land Surveyor, or other duly authorized official)

Office of Register of Deeds, County of....., I hereby certify that the within instrument was filed in this office for record on the.....day of....., 19..... at.....o'clock..... M.

(Register of Deeds)

By.....Deputy

4331234 2000 2008

FORM 985 H. C. MILLER CO., MILWAUKEE

4331234 2000

# East 1/4 corner, Sec 34, T33N, R12E

10/13/08 Update

1930's resurvey: "to 1/4 cor. 34 - 35. Found stake and remains of Maple SE. New B.O. Grey Stone, 2 1/2' x 3'. S27E, 2 links.

08/1976 Former surveyor found 4" iron pipe with brass cap and marked three bearing trees.

10/08/08 D. Tlusty. Found 4" iron pipe with brass cap, top up 2.5' and loose in ground. Redug and reset so top is now up 0.4' in small mound of stones. Found grey stone, 2 1/2' x 3', S27E, 1.32 ft' to faint chiseled X on top - this is the 1930's B.O. (bearing object). I marked a new bearing stone by chiseling a "+" on top of 2.5' x 3' x 1' tall pink granite rock, S54°30'W, 23.32 ft.

Static GPS'ed corner monument and new bearing stone - results shown below. Notes FB13-22.

Spectrum® Survey 3.50

POINT EXPORT

Project: C:\...\Sokkia\Common\Spectrum Projects\25-33-12.spr

Coordinate System: Langlade [Lambert Conform...] Datum: NAD83

Geoid Model: GEOID1 Units: US Feet

Export Date: 2008/10/13 11:59:21 (Local) Time Zone: GMT-5.00h

00252832,398039.714,667782.352,1652.953,w/n X on rock  
00252831,398054.470,667800.394,1650.858,4"ip bc el/4 s34

