

CERTIFIED LAND CORNER RESTORATION

Index No. A-17

32-12

State of Wisconsin }
County of Lanlgade } ss.

I Raymond J. Hallisy, do hereby certify that on the 3rd day of December, 1977, I found evidence of the Section corner of 2, 3, 34, & 35 Township 33 & 32, North, Range 12E, Fourth Principal Meridian, as described hereon; and that from this evidence I established a new monument and accessories as described hereon to perpetuate the original location of this corner.

Resident witnesses:

.....
.....
.....

History of original corner establishment:

Corner set in the 1930 resurvey.

Description of corner evidence found:

4" iron pipe with brass cap
Old BT's 24" Hard Maple N80W 33.4 Links
18" Elm N45E 56.2 Links

Description of monument and accessories I established to perpetuate the original location of this corner.

New BT's

10" Basswood S62W 23' 3"
8" Hard Maple N67E 49'
12" Hard Maple N52W 55' 6"

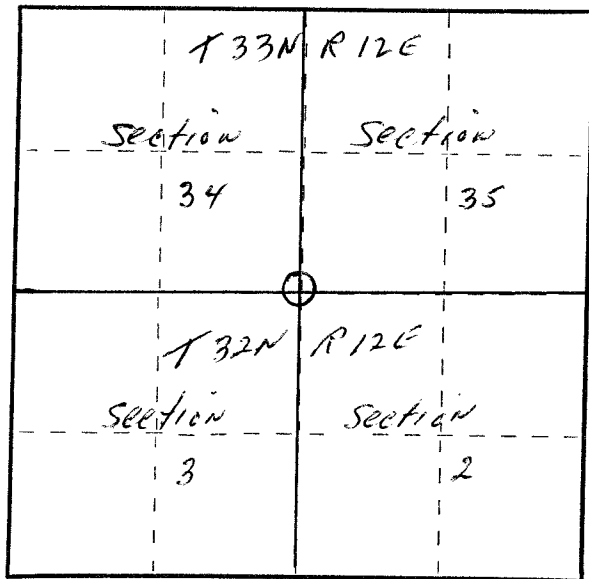
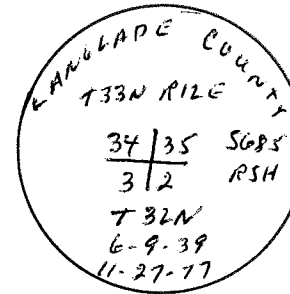

○ = Corner monument restored.

Dated at Antigo, Wis., this 3rd day of December, 1977.

Signature Raymond J. Hallisy Title Land Surveyor Registration No. S685
(County Surveyor, Registered Land Surveyor, or other duly authorized official)

Office of Register of Deeds, County of....., I hereby certify that the within instrument was filed in this office for record on the.....day of....., 19..... at.....o'clock..... M.

.....
(Register of Deeds)

By.....Deputy

FORM 985 R. C. MILLER CO., MILWAUKEE