

CERTIFIED LAND CORNER RESTORATION

Index No. A-5

State of Wisconsin }
County of Langlade } ss.

History of original corner establishment:

Corner set in the 1930 resurvey.

I, Raymond J. Hallisy, do hereby certify that on the 21st day of July, 1979, I found evidence of the Section corner of 6, 31, 5, & 32 Township 32 & 33, North, Range 12E, Fourth Principal Meridian, as described hereon; and that from this evidence I established a new monument and accessories as described hereon to perpetuate the original location of this corner.

Description of corner evidence found:

4" pipe with brass cap, rock mound.

Resident witnesses:

.....
.....
.....

Description of monument and accessories I established to perpetuate the original location of this corner.

New BT's

5"	Hard Maple	N70E	25' 2"
6"	Clump Hard Maple	S50E	11'
5"	Hard Maple	S17W	15' 11"
6"	Hard Maple	N26W	8' 11"

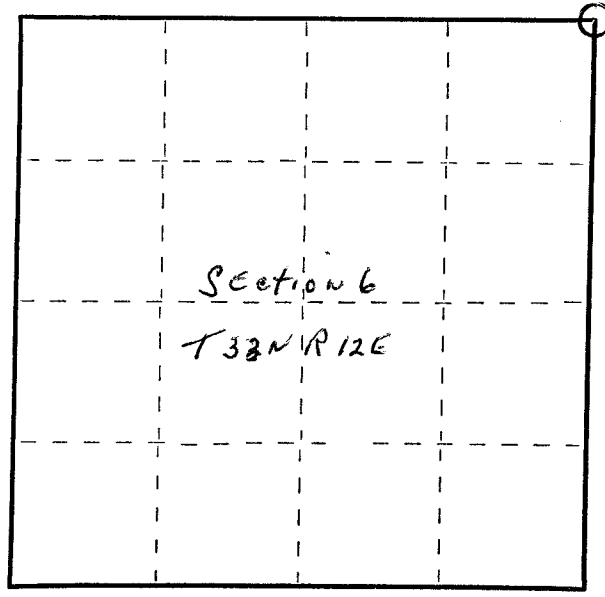
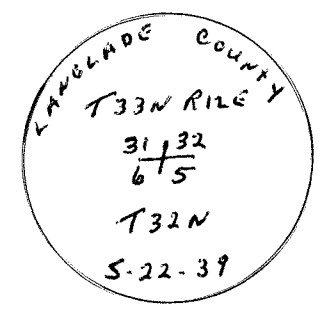

○ = Corner monument restored.

Dated at Antigo, Wis., this 21st day of July, 1979.

Signature Raymond J. Hallisy Title Reg. Surveyor Registration No. S685
(County Surveyor, Registered Land Surveyor, or other duly authorized official)

Office of Register of Deeds, County of....., I hereby certify that the within instrument was filed in this office for record on the..... day of....., 19..... at..... o'clock..... M.

.....
(Register of Deeds)

By..... Deputy

FORM 985 H. C. MILLER CO., MILWAUKEE