

CERTIFIED LAND CORNER RESTORATION

Index No. 7-13

State of Wisconsin }  
County of Lanlade } ss.

I, Raymond J. Hallisy, do hereby certify that on the 18th day of October, 1980, I found evidence of the 1/4 corner of Section 27 & 28 Township 33, North, Range 12E, Fourth Principal Meridian, as described hereon; and that from this evidence I established a new monument and accessories as described hereon to perpetuate the original location of this corner.

Resident witnesses:

.....  
.....  
.....

FORM 985 H. C. MILLER CO., MILWAUKEE

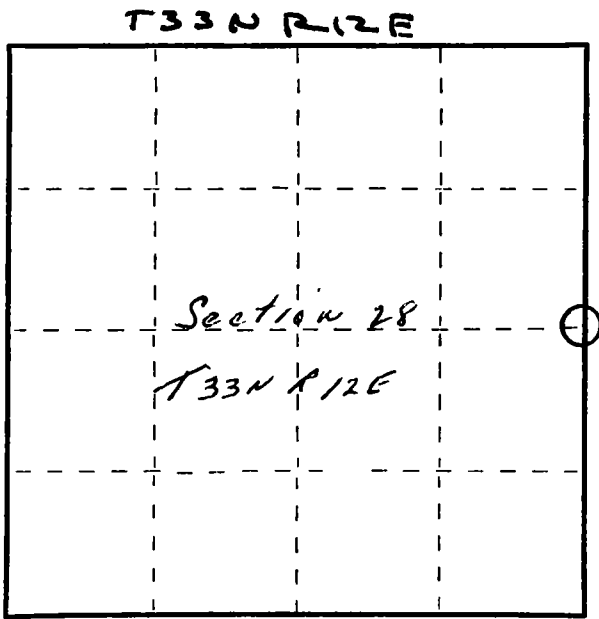

○ = Corner monument restored.

History of original corner establishment:

Corner reset in the 1930 resurvey.

Description of corner evidence found:

Stone with X and <sup>4"</sup> pipe with brass cap as Witness Corner 2 Links ~~5000~~ South.  
BT  
Maple 26" S70E 20 Links (original) live.  
Maple 20" N28E 74.5 Links

Description of monument and accessories I established to perpetuate the original location of this corner.

New BT's to true corner

6" Basswood S58E 16'5"  
5" Twin Elm S10W 17'4"  
12" Aspen S50W 17'9"

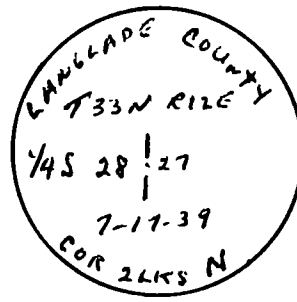

Dated at Antigo, Wis., this 18th day of October, 1980.

Signature Raymond J. Hallisy Title Res. Surveyor Registration No. S-685  
(County Surveyor, Registered Land Surveyor, or other duly authorized official)

Office of Register of Deeds, County of....., I hereby certify that the within instrument was filed in this office for record on the..... day of....., 19..... at..... o'clock..... M.

.....  
(Register of Deeds)

By..... Deputy