

CERTIFIED LAND CORNER RESTORATION

Index No. 3-17

State of Wisconsin }
County of Langlade } ss.

I Raymond J. Hallisy, do hereby certify that on the 4th day of May, 19 69, I found evidence of the N 1/16 corner of Section 26 Township 33, North, Range 12E, Fourth, Principal Meridian, as described hereon; and that from this evidence I established a new monument and accessories as described hereon to perpetuate the original location of this corner.

History of original corner establishment:

Corner set in the 1930 resurvey.

Description of corner evidence found:

Found squared stake down point in ground. Marked N 1/16 S26 S27

Resident witnesses:

.....
.....
.....

Description of monument and accessories I established to perpetuate the original location of this corner.

Set 2" pipe with brass cap and rock mound.
B.T.'s to corner
Red Maple 7" S46W 2Ft. 8 inches
Red Maple 4" N34E 8Ft. 3 inches
B.T.'s faced at base and scribed BT

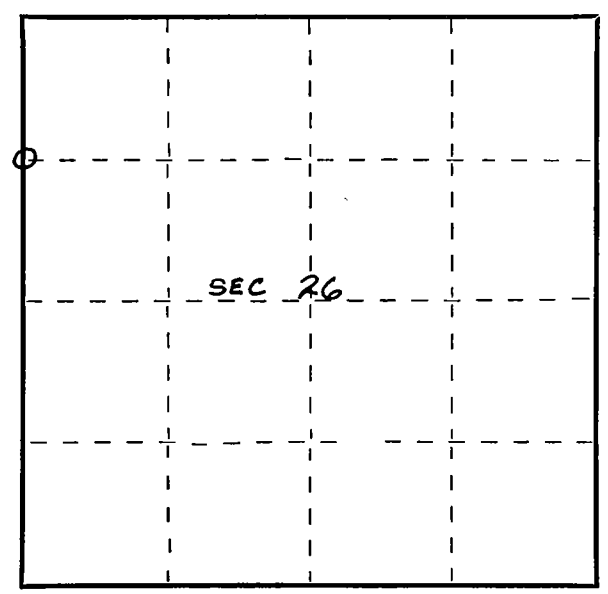
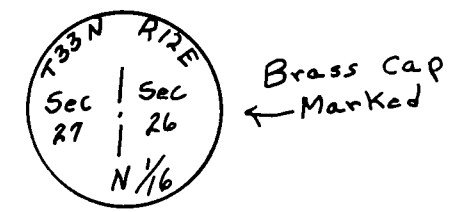

○ = Corner monument restored.

Dated at Antigo, Wis., this 4th day of May, 19 69.

Signature Raymond J. Hallisy Title Reg. Land Surveyor Registration No. 3-685
(County Surveyor, Registered Land Surveyor, or other duly authorized official)

Office of Register of Deeds, County of....., I hereby certify that the within instrument was filed in this office for record on the..... day of....., 19..... at..... o'clock..... M.

.....
(Register of Deeds)

By..... Deputy

FORM 985 H. C. MILLER CO., MILWAUKEE