

CERTIFIED LAND CORNER RESTORATION

33-12

Index No. S-21

State of Wisconsin }
County of Lanlade } ss.

I, Raymond J. Hallisy, do hereby certify that on the 3rd day of July, 1971, I found evidence of the N. 1/16 corner of Section 25 & 26 Township 33, North, Range 12E, Fourth, Principal Meridian, as described hereon; and that from this evidence I established a new monument and accessories as described hereon to perpetuate the original location of this corner.

History of original corner establishment: ...
Corner set in the 1930 resurvey.

Description of corner evidence found:

Found old wood stake down, point in ground in good shape.
Marked N 1/16 S25 S26

Resident witnesses:

.....
.....
.....

Description of monument and accessories I established to perpetuate the original location of this corner.

Set 2" pipe with brass cap

BT's to corner

Black Ash 11" S76W 39.2 Feet

Cedar Snag 15" N23W 13.5 Feet

BT's faced at base of tree and scribed BT



FORM 985 M. C. MILLER CO., MILWAUKEE

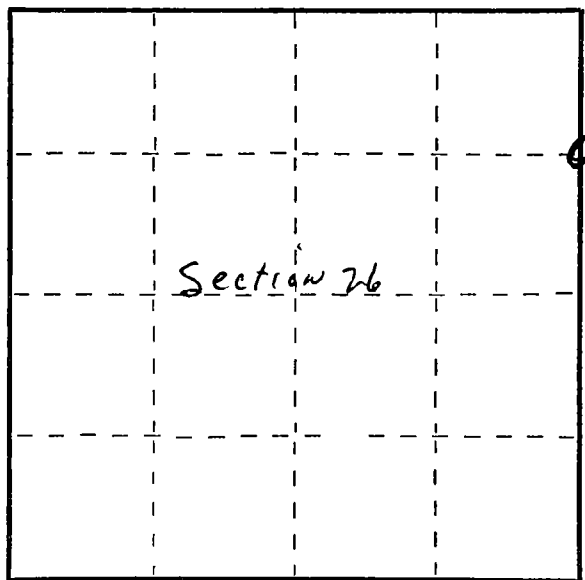

○ = Corner monument restored.

Dated at Antigo, Wis., this 3rd day of July, 1971.

Signature R. J. Hallisy Title Reg. Land Surveyor Registration No. 685
(County Surveyor, Registered Land Surveyor, or other duly authorized official)

Office of Register of Deeds, County of....., I hereby certify that the within instrument was filed in this office for record on the.....day of....., 19..... at.....o'clock..... M.

(Register of Deeds)

By.....Deputy