

CERTIFIED LAND CORNER RESTORATION

33-12

Index No. U-21

State of Wisconsin }
County of Langlade } ss.

I, Raymond J. Hallisy, do hereby certify that on the 4th day of May, 1969, I found evidence of the S. 1/16 corner of Section 25 Township 33, North, Range 12E, Fourth, Principal Meridian, as described hereon; and that from this evidence I established a new monument and accessories as described hereon to perpetuate the original location of this corner.

Resident witnesses:

.....
.....
.....

History of original corner establishment:

Corner set in the 1930 resurvey.

Description of corner evidence found:

Found old stake down. WCD location tag.

Description of monument and accessories I established to perpetuate the original location of this corner.

Set 2" pipe with brass cap and rock mound
B.T.'s to corner
Hard maple 7" S77W 11Ft. 8 inches
Hard maple 7" S45E 13Ft. 1 inch
B.T.'s faced at base and scribed BT

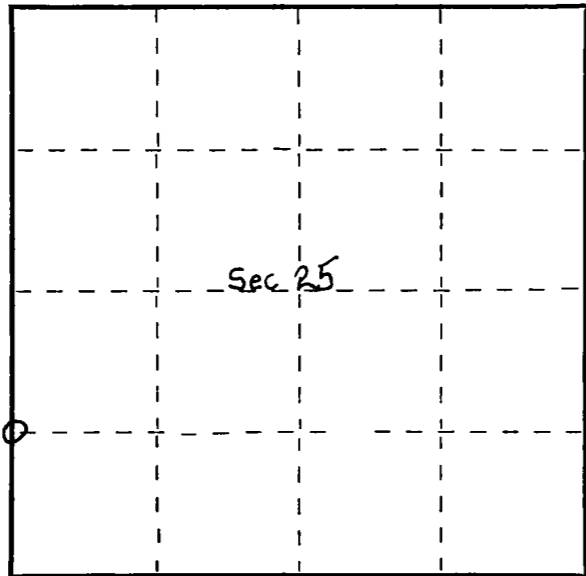
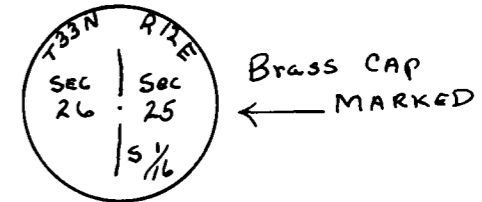

○ = Corner monument restored.

Dated at Antigo, Wis., this 4th day of May, 1969.

Signature Raymond J. Hallisy Title Reg. Land Surveyor Registration No. S-685
(County Surveyor, Registered Land Surveyor, or other duly authorized official)

Office of Register of Deeds, County of....., I hereby certify that the within instrument was filed in this office for record on the..... day of....., 19..... at..... o'clock..... M.

.....
(Register of Deeds)

By..... Deputy