

CERTIFIED LAND CORNER RESTORATION

Index No. P-25

State of Wisconsin }
County of Langlade } ss.

History of original corner establishment:
1939 RESURVEY

I Raymond J. Hallisy, do hereby certify that on the 21st day of April, 1979, I found evidence of the 1/4 corner of Section 19, 24 Township 33, North, Range 12, 13 EAST, Fourth Principal Meridian, as described hereon; and that from this evidence I established a new monument and accessories as described hereon to perpetuate the original location of this corner.

Description of corner evidence found:
1/2 inch Iron pipe with Brass cap
Rock mound
old B.T.
Cedar stump 8" N37E 22.7 LKS

Resident witnesses:

Description of monument and accessories I established to perpetuate the original location of this corner.

New B.T.s
BALSAM 6" N32W 8 LKS
" 4" 90W 8.8 LKS
Aspen 7" N44E 27.7 LKS

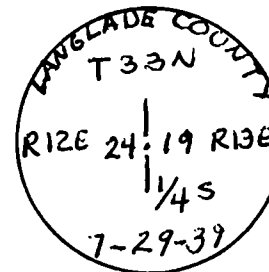

FORM 985 H. C. MILLER CO., MILWAUKEE

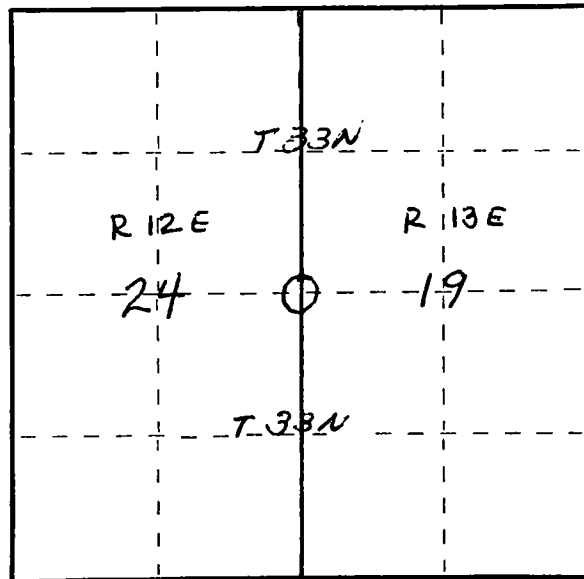

○ = Corner monument restored.

Dated at Antigo, Wis., this 21st day of April, 1979.

Signature Raymond J. Hallisy Title Reg. Land Surveyor Registration No. 5685
(County Surveyor, Registered Land Surveyor, or other duly authorized official)

Office of Register of Deeds, County of _____, I hereby certify that the within instrument was filed in this office for record on the _____ day of _____, 19____ at _____ o'clock _____ M.

(Register of Deeds)

By _____ Deputy