

CERTIFIED LAND CORNER RESTORATION

Index No. R-10

State of Wisconsin }  
County of Lanlade } ss.

I, Raymond J. Hallisy, do hereby certify that on the 19th day of June, 1977, I found evidence of the West 1/16 corner of Section 21 & 28 Township 33, North, Range 12E, Fourth Principal Meridian, as described hereon; and that from this evidence I established a new monument and accessories as described hereon to perpetuate the original location of this corner.

Resident witnesses:

.....  
.....  
.....

History of original corner establishment:

Corner set in the 1930 resurvey.

Description of corner evidence found:

Found wood post standing, rock mound, Location poster north on old road.  
Post marked 1/16 28 21

Description of monument and accessories I established to perpetuate the original location of this corner.

New BT's

5" Spruce N63E 14.6 Ft.  
5" Red Maple S63W 4 Ft.

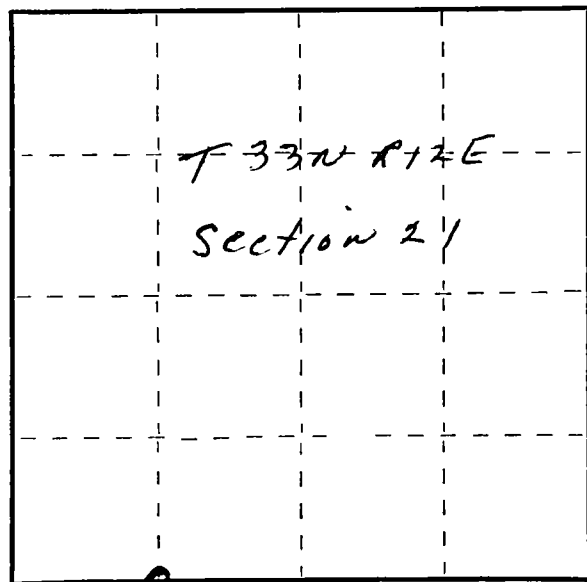
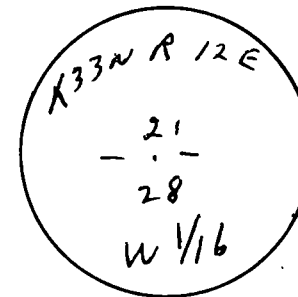

○ = Corner monument restored.

Dated at Antigo, Wis., this 19th day of June, 1977

Signature Raymond J. Hallisy Title Land Surveyor Registration No. 5685  
(County Surveyor, Registered Land Surveyor, or other duly authorized official)

Office of Register of Deeds, County of \_\_\_\_\_, I hereby certify that the within instrument was filed in this office for record on the \_\_\_\_\_ day of \_\_\_\_\_, 19\_\_\_\_ at \_\_\_\_\_ o'clock \_\_\_\_\_ M.

.....  
(Register of Deeds)

By.....Deputy

FORM 985 M. C. MILLER CO., MILWAUKEE