

CERTIFIED LAND CORNER RESTORATION

Index No. R-7

State of Wisconsin }
 County of Lamlade } ss.

I, Raymond J. Hallisy, do hereby certify that on the 4th day of December, 1982, I found evidence of the 1/4 corner of Section 20 & 29 Township 33, North, Range 13E, Fourth Principal Meridian, as described hereon; and that from this evidence I established a new monument and accessories as described hereon to perpetuate the original location of this corner.

Resident witnesses:

.....

.....

.....

History of original corner establishment:

Corner set in the 1930 resurvey.

Description of corner evidence found:

4" pipe with brass cap, 1 1/2" well pipe alongside.

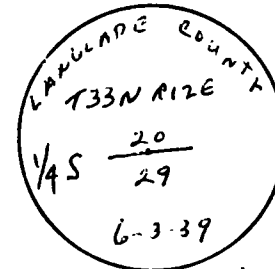

Description of monument and accessories I established to perpetuate the original location of this corner.

New BT's

5" Black spruce	S65W	3.7'
4" Black Spruce	S48E	8.5'
4" Twin Black Spruce	N27E	19.5'
6" Blace Spruce	N71W	10.5'

FORM 985 M. C. MILLER CO., MILWAUKEE

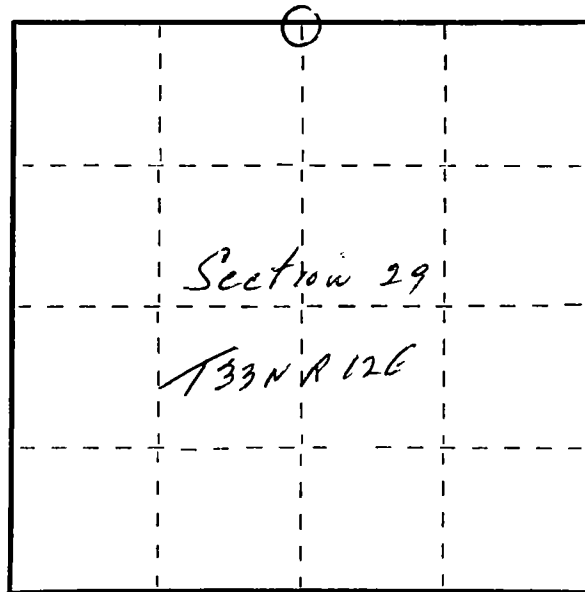

○ = Corner monument restored.

Dated at Antigo, Wis., this 4th day of December, 1982

Signature Raymond J. Hallisy Title Land Surveyor Registration No. S-685
 (County Surveyor, Registered Land Surveyor, or other duly authorized official)

Office of Register of Deeds, County of....., I hereby certify that the within instrument was filed in this office for record on the.....day of....., 19..... at..... o'clock..... M.

.....
 (Register of Deeds)

By.....Deputy