

CERTIFIED LAND CORNER RESTORATION

Index No. N-11

State of Wisconsin }
County of Langlade } ss.

I, Raymond J. Hallisy, do hereby certify that on the 18th day of December, 1982, I found evidence of the 1/4 corner of Section 16 & 21 Township 33 North, Range 12E, Fourth Principal Meridian, as described hereon; and that from this evidence I established a new monument and accessories as described hereon to perpetuate the original location of this corner.

Resident witnesses:

.....
.....
.....

History of original corner establishment:

Corner set in the 1930 resurvey.

Description of corner evidence found:

4" pipe with brass cap as witness corner to Stone with X 2 lks West.

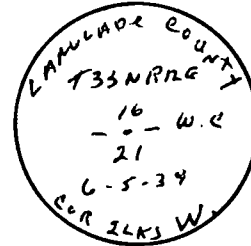

Description of monument and accessories I established to perpetuate the original location of this corner.

New BT'S to stone with X

5"	Clump Hard Maple	S11E	12.1'
12"	Hard Maple	S46E	24.7'
6"	Hard Maple	S76E	24.3'
5"	Hard Maple	S88E	22.9'

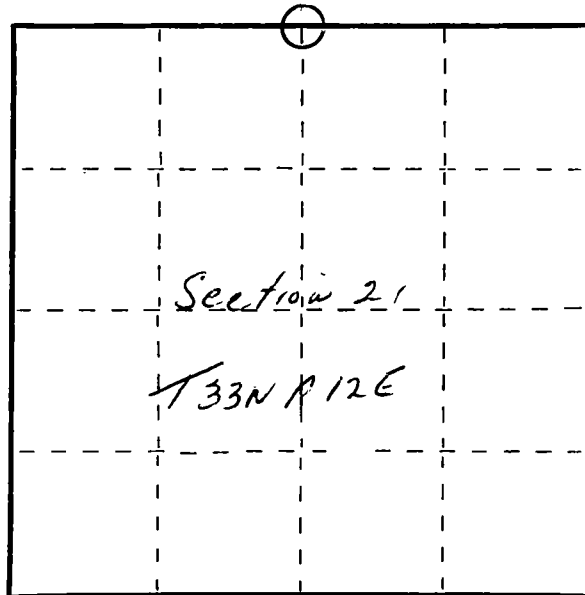

○ = Corner monument restored.

Dated at Antigo, Wis., this 18th day of December, 1982

Signature: Raymond J. Hallisy, Land Surveyor, Registration No. S-685
(County Surveyor, Registered Land Surveyor, or other duly authorized official)

Office of Register of Deeds, County of _____, I hereby certify that the within instrument was filed in this office for record on the _____ day of _____, 19____ at _____ o'clock _____ M.

(Register of Deeds)

By _____ Deputy

FORM 985 R. C. MILLER CO., MILWAUKEE