

CERTIFIED LAND CORNER RESTORATION

Index No. N-13

State of Wisconsin }
County of Langlade } ss.

I Raymond J. Hallisy, do hereby certify that on the 18th day of December, 19 82, I found evidence of the Section corner of 16, 15, 21, & 22 Township 33, North, Range 12E, Fourth Principal Meridian, as described hereon; and that from this evidence I established a new monument and accessories as described hereon to perpetuate the original location of this corner.

Resident witnesses:

History of original corner establishment:

Corner set in the 1930 resurvey.

Description of corner evidence found:

4" pine with brass cap as witness corner to Stone with X 2 lks north; rock mound.

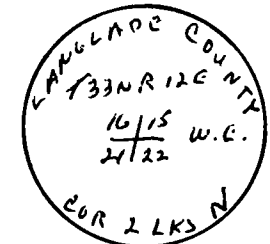

Description of monument and accessories I established to perpetuate the original location of this corner.

New BT's to Stone with X

4" Hard Maple	S20E	13.1'
8" Basswood	S19W	12.3'
6" Basswood	S88W	6.4'
6" Hard Maple	N88E	5.1'

FORM 985 M. C. MILLER CO., MILWAUKEE

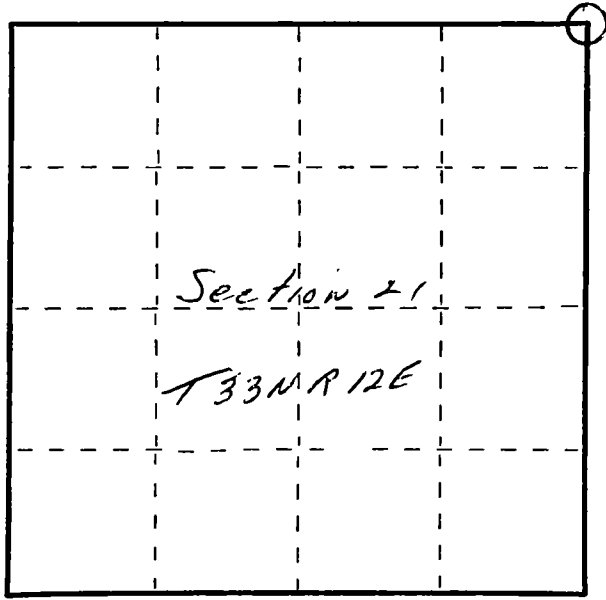

○ = Corner monument restored.

Dated at Antigo, Wis., this 18th day of December, 19 82.

Signature Raymond J. Hallisy Title Land Surveyor Registration No. S-685
(County Surveyor, Registered Land Surveyor, or other duly authorized official)

Office of Register of Deeds, County of _____, I hereby certify that the within instrument was filed in this office for record on the _____ day of _____, 19 _____ at _____ o'clock _____ M.

(Register of Deeds)

By _____ Deputy