

CERTIFIED LAND CORNER RESTORATION

Index No. N-157

State of Wisconsin }
County of LANGLADE } ss.

I RAYMOND S HALLISY, do hereby certify that on the 23RD day of MARCH, 1985, I found evidence of the Y4 corner of SECTION 15 & 22 Township 33, North, Range 12 E, Fourth Principal Meridian, as described hereon; and that from this evidence I established a new monument and accessories as described hereon to perpetuate the original location of this corner.

Resident witnesses:

.....
.....
.....

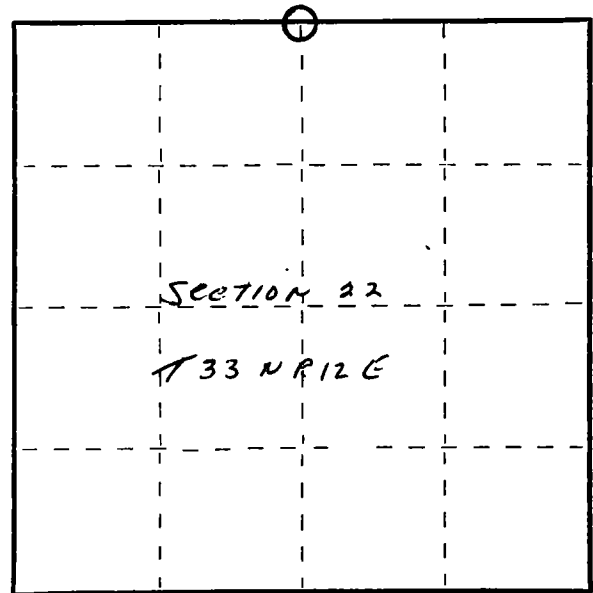

○ = Corner monument restored.

History of original corner establishment:

1930 RESURVEY

Description of corner evidence found:

4" IRON PIPE WITH BRASS CAP

Description of monument and accessories I established to perpetuate the original location of this corner.

NEW BT'S

8" HARD MAPLE N16 W 10'
5" BASSWOOD S50 W 5.5'
5" HARD MAPLE S 8 E 15.9'
5" HARD MAPLE S 47 E 12.8'

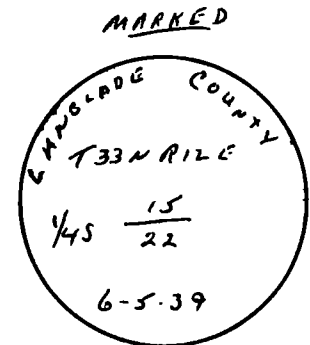

Dated at ANTIGO, Wis., this 23RD day of MARCH, 1985

Signature Raymond S. Hallisy Title LAND SURVEYOR Registration No. S-685
(County Surveyor, Registered Land Surveyor, or other duly authorized official)

Office of Register of Deeds, County of _____, I hereby certify that the within instrument was filed in this office for record on the _____ day of _____, 19____ at _____ o'clock _____ M.

.....
(Register of Deeds)

By _____ Deputy