

CERTIFIED LAND CORNER RESTORATION

33-12

Index No. N-18

State of Wisconsin }
County of Langlade } ss.

I Raymond J. Hallisy, do hereby
certify that on the 21st day
of June, 1969, I found
evidence of the W 1/16
corner of Section 23
Township 33, North, Range
12E, Fourth, Principal Meridian,
as described hereon; and that from this evidence
I established a new monument and accessories
as described hereon to perpetuate the original
location of this corner.

History of original corner establishment:

~~XXXX~~

Set in the 1930 resurvey.

Description of corner evidence found:

Found old wood post standing, marked W1/16 S23 S14 Cor 1 Rod N
Also 1 1/2" iron pipe on north side of post.

Resident witnesses:

.....
.....
.....

Description of monument and accessories I established to perpetuate the original location of this corner.

Reset 2" iron pipe with brass cap and rock mound, as witness corner.
This corner is set on south side of town road.

B.T.'s to witness corner
Hard Maple clump 4" S25W 16 Ft. 1 inch
White Birch 8" S68W 21 Ft. 1 inch
B.T.'s faced at base and scribed BT

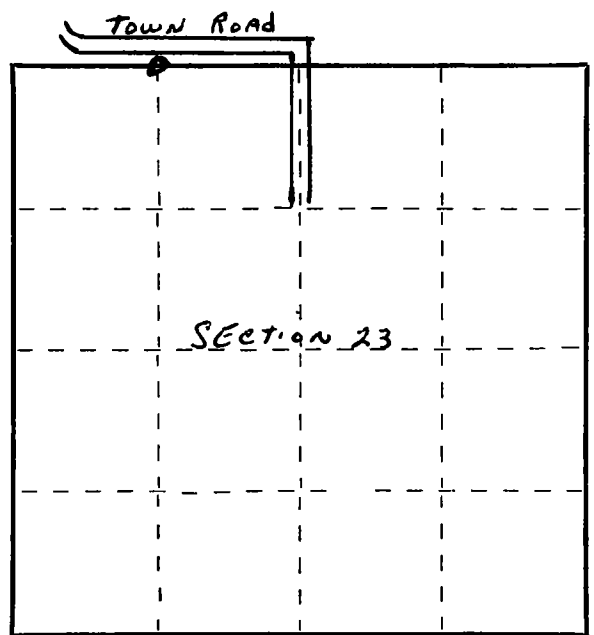
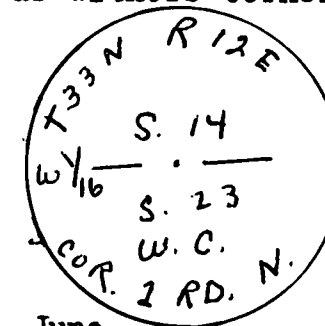

Dated at Antigo, Wis., this 21st day of June, 1969

Signature Raymond J. Hallisy Title Reg. Land Surveyor Registration No. S-685
(County Surveyor, Registered Land Surveyor, or other duly authorized official)

Office of Register of Deeds, County of _____, I hereby certify that the within
instrument was filed in this office for record on the _____ day of _____, 19____
at _____ o'clock _____ M.

(Register of Deeds)

By _____ Deputy

○ = Corner monument restored.