

CERTIFIED LAND CORNER RESTORATION

33-12

Index No. G-22

State of Wisconsin }
County of Langlade } ss.

History of original corner establishment:

Corner set in the 1920's by M. Hutchinson.

I, Raymond J. Hallisy, do hereby certify that on the 2nd day of May, 1970, I found evidence of the West Center 1/16 corner of Section 12 Township T33, North, Range 12E, Fourth, Principal Meridian, as described hereon; and that from this evidence I established a new monument and accessories as described hereon to perpetuate the original location of this corner.

Description of corner evidence found:

Found 24" Pine Stump BT N42½E 28½ Links, marks plain, hole from stake in right location.

Resident witnesses:

J. Weiss
J. Krupka

Description of monument and accessories I established to perpetuate the original location of this corner.

Set 2" pipe with brass cap.

New B.T.'S

Hard Maple 10" N50W 31.4 Links

Yellow Birch 6" S20E 26.9 Links

B.T.'s faced at base of tree and scribed BT.

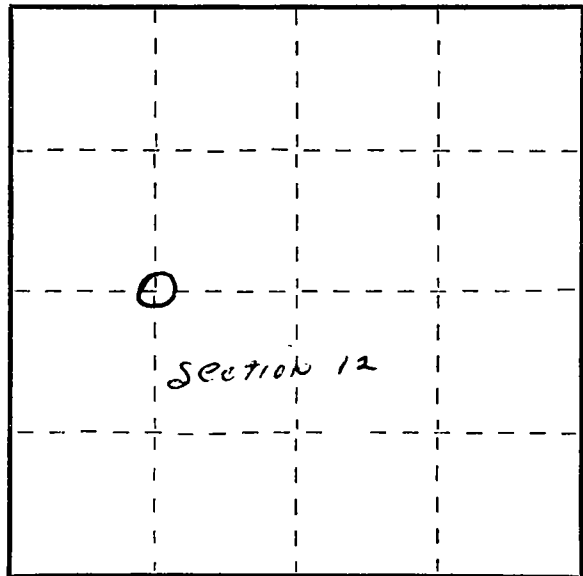
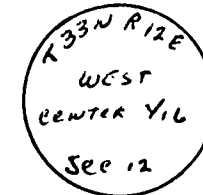

Dated at Antigo, Wis., this 2nd day of May, 1970

Signature Raymond J. Hallisy Title Reg. Land Surveyor Registration No. S-685
(County Surveyor, Registered Land Surveyor, or other duly authorized official)

Office of Register of Deeds, County of _____, I hereby certify that the within instrument was filed in this office for record on the _____ day of _____, 19____ at _____ o'clock _____ M.

(Register of Deeds)

By _____ Deputy

○ = Corner monument restored.