

CERTIFIED LAND CORNER RESTORATION

33-12

Index No. G-24

State of Wisconsin }
County of Langlade } ss.

I, Raymond J. Hallisy, do hereby certify that on the 5th day of July, 19 71, I found evidence of the East Center 1/16 corner of Section 12 Township 33, North, Range 12E, Fourth, Principal Meridian, as described hereon; and that from this evidence I established a new monument and accessories as described hereon to perpetuate the original location of this corner.

Resident witnesses:

.....
.....
.....

FORM 985 H. C. MILLER CO., MILWAUKEE

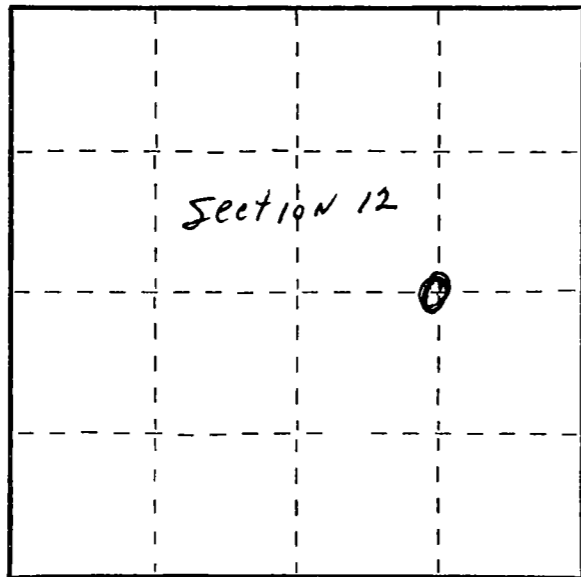

○ = Corner monument restored.

History of original corner establishment:

Corner set by M. Hutch inson

Description of corner evidence found:

Found squared wood post in open marsh

Description of monument and accessories I established to perpetuate the original location of this corner.

Set 2" pipe with brass cap alongside post

BT's to corner

Black Spruce 3" N32W 16 Feet 5 inches
Black Spruce 6" S52 W 17 Feet 4 inches

BT's faced at base of tree and scribed BT



Dated at Antigo, Wis., this 5th day of July, 19 71

Signature [Signature] Title Reg. Land Surveyor Registration No. 685
(County Surveyor, Registered Land Surveyor, or other duly authorized official)

Office of Register of Deeds, County of....., I hereby certify that the within instrument was filed in this office for record on the.....day of....., 19..... at.....o'clock..... M.

.....
(Register of Deeds)

By.....Deputy