

CERTIFIED LAND CORNER RESTORATION

State of Wisconsin }
County of LANGLADE } ss.

I, ROBERT J. POSS, do hereby certify that on the 20TH day of JUNE, 1968, I found evidence of the 1/4 COR. corner of SEC. 12 & 7 Township 33 NORTH, North, Ranges 12 & 13 EAST, Fourth, Principal Meridian, as described hereon; and that from this evidence I established a new monument and accessories as described hereon to perpetuate the original location of this corner.

Resident witnesses:
Anton Gureski:

History of original corner establishment:

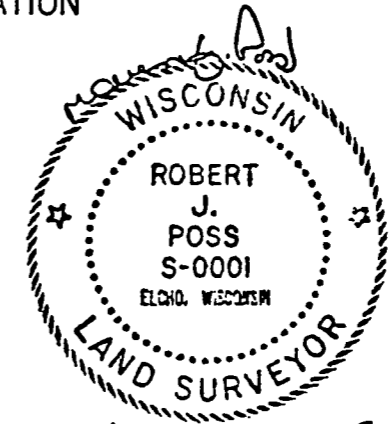

Description of corner evidence found:

ANTONE GURESKI INDICATED LOCATION OF COR. AT JUNCTION OF 4 OLD FENCES. GURESKI IS LONG TIME (82 YRS.) RESIDENT & LAND OWNER. HAD SEEN STAKE AT THE COR. FOUND OLD STAKE SHELLED - BADLY BURNED - BUT FOUND PT. OF STAKE DOWN ABOUT 3/4 FT.

Description of monument and accessories I established to perpetuate the original location of this corner.

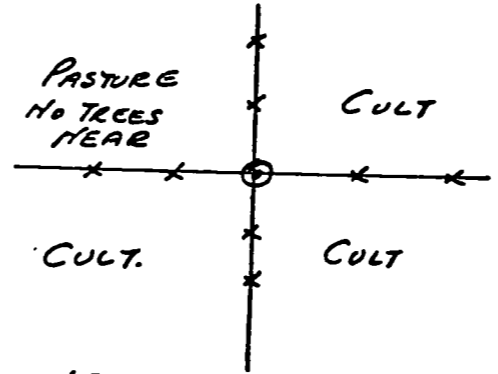

⊙
BRASS CAP
CONC. MONUMENT
MKD.
1/4 COR
SEC. 12 SEC. 7
12 1
T53N
R12E R13E

FORM 985 W. C. MILLER CO., MILWAUKEE

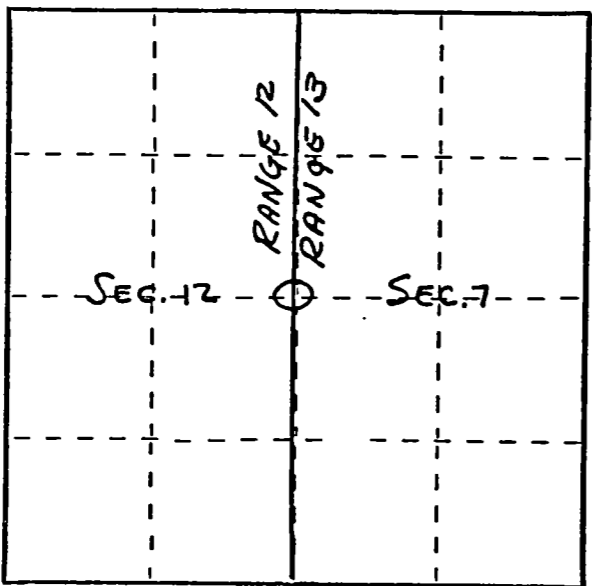

BAS. ARE MAP

Dated at ELCHO, Wis., this 21ST day of JUNE, 1968.

Signature Robert J. Poss Title REG. LAND SURVEYOR Registration No. 5-1
(County Surveyor, Registered Land Surveyor, or other duly authorized official)

Office of Register of Deeds, County of _____, I hereby certify that the within instrument was filed in this office for record on the _____ day of _____, 19____ at _____ o'clock _____ M.

(Register of Deeds)
By _____ Deputy

○ = Corner monument restored.